

### Features & Benefits

- Perfectly matched OEM profiles for easy switch with OEM fittings
- Graded fasteners & prime steel grade ensure excellent service life
- Excellent coverage across European truck & trailer applications

**BPW | DAF | FRUEHAUF  
MAN | SCANIA | VOLVO  
WABCO**



**200.2018.S**

OEM#	APPLICATIONS
02.331.00.70.0S	BPW TRAILERS
1505418S	DAF TRUCKS
D14353S	FRUEHAUF
81.00000.0483S	MAN TRUCKS
47557-D8800S	NISSAN
1934813S	SCANIA L, P, G, R, S SERIES TRUCKS
4519992062S	VOLVO
451 999 206 2S	WABCO

**DAF | SCANIA | WABCO**



**200.2021.S**

OEM#	APPLICATIONS
1505421S	DAF TRUCKS
1934816S	SCANIA L, P, G, R, S SERIES TRUCKS
451 999 310 2S	WABCO

**BPW | DAF | SCANIA | WABCO**



**200.2022.S**

OEM#	APPLICATIONS
02.331.01.00.0S	BPW TRAILERS
1506063S	DAF TRUCKS
1967627S	SCANIA TRUCKS
1934817S	SCANIA TRUCKS
451 999 396 2S	WABCO

**BPW | DAF | SAF HOLLAND  
SCANIA | WABCO**



**200.2020.S**

OEM#	APPLICATIONS
02.331.01.10.0S	BPW TRAILERS
1505420S	DAF TRUCKS
1967625S	DAF TRUCKS
4405000900S	SAF HOLLAND
1934815S	SCANIA L, P, G, R, S SERIES TRUCKS, 3 SERIES BUS
451 999 276 2S	WABCO

**BPW | DAF | SCANIA  
VOLVO | WABCO**



**200.2019.S**

OEM#	APPLICATIONS
02.331.00.90.0S	BPW TRAILERS
1505419S	DAF TRUCKS
1967624S	DAF TRUCKS
S4050024600S	SAF HOLLAND
1934814S	SCANIA F, K, L, N SERIES BUS
4519992462S	VOLVO
451 999 246 2S	WABCO

### SCANIA



**100.2369.S**

OEM#	APPLICATIONS
1455775S	SCANIA L, P, G, R, S, P, G, R, T SERIES TRUCKS

### MAN | VOLKSWAGEN



**400.1822.S**

OEM#	APPLICATIONS
81.97460.6042S	MAN TGL, TGM, TGA, TGS, TGX SERIES TRUCKS
2V5616847AS	VOLKSWAGEN

### IVECO

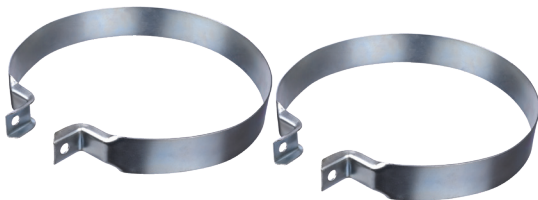

**750.1433.S**

OEM#	APPLICATIONS
2519815S	IVECO EUROCARGO, EUROTECH, EUROTRAKKER, STRALIS SERIES TRUCKS