

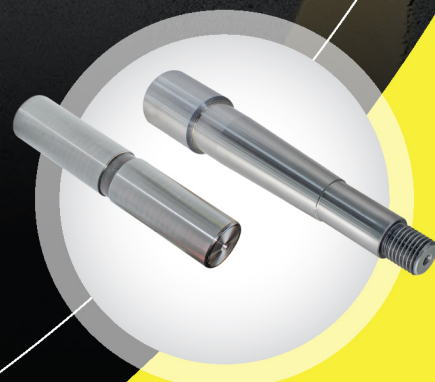

NPA 1043 (Updated May 2024)

EUROPEAN TRUCK & TRAILER KING PIN REPAIR KITS



Our Product Categories

AIR BRAKE



ANTI-VIBRATION



AXLE



BODY



CABIN



FIFTH WHEEL & DRAW BAR



DRIVELINE



EXHAUST



ENGINE & TRANSMISSION



STEERING



SUSPENSION



INTERMODAL



PU COMPONENTS







LUBRICANTS



Sr. #	Sections	Page
	TRUCK APPLICATION	
1	DAF	04-05
2	DAIHATSU	05-05
3	HINO	06-06
4	HYUNDAI.....	06-06
5	ISUZU.....	06-06
6	IVECO	06-07
7	MAN	07-09
8	MERCEDES	09-12
9	MITSUBISHI	12-12
10	RENAULT	13-15
11	SCANIA	15-15
12	VOLVO	15-17
	TRAILER APPLICATION	
13	BPW	18-18
14	MERITOR	18-18
	CROSS REF.....	19-19

- 14 Brands
- 16 part numbers with **EURO 6** applications
- OEM equivalent materials grade to meet service life expectations



Comprehensive range of 80 repair kits for Asian & European applications	
Precision machined & heat treated to perfection	
2 years product warranty	



200.037.00

KING PIN REPAIR KIT

OEM #
0680374
0681621

APPLICATION
DAF F1900/2100, CF65,
CF75, CF85, XF 95, LF 45
SERIES TRUCKS



DOUBLE KIT# 200.037
OEM# 0680374S1, 0681621S1

200.068.00

KING PIN REPAIR KIT

OEM #
0683469, 895530
683469

APPLICATION
DAF LF 45 SERIES
TRUCKS



DOUBLE KIT# 200.068
OEM# 1895530S1, 683469S1

200.069.00

KING PIN REPAIR KIT

OEM #
0683485
1895527

APPLICATION
DAF LF 45, LF 55 SERIES
TRUCKS



DOUBLE KIT# 200.069
OEM# 0683485S1, 1895527S1

200.121.00

KING PIN REPAIR KIT

OEM #
0683499
1895529

APPLICATION
DAF 65CF, 75CF, 85CF,
CF65, CF75, CF85, XF95,
XF105 SERIES TRUCKS



DOUBLE KIT# 200.121
OEM# 0683499S1, 1895529S1



200.173.00

KING PIN REPAIR KIT

OEM #
KPKW009

APPLICATION
DAF 70, 80, 90 FOR
CONSTRUCTOR,
FREIGHTER ROADTRAIN
TRUCKS



DOUBLE KIT# 200.173
OEM# KPKW009S1

200.174.00

KING PIN REPAIR KIT

OEM #
KPKW030

APPLICATION
DAF FA 45 SERIES
TRUCKS FOR LEYLAND
DAF ROAD RUNNER



DOUBLE KIT# 200.174
OEM# KPKW030S1

200.176.00

KING PIN REPAIR KIT

OEM #
KPK8, KPKW008
APPLICATION
DAF 7.5 TON FA45
SERIES TRUCKS



DOUBLE KIT# 200.176
OEM# KPK8S1, KPKW008S1

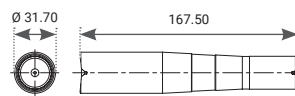

200.221.00

KING PIN REPAIR KIT

OEM #
0681706S
0683405S
APPLICATION
DAF CF65, CF75, CF85,
XF95, F65, F75, F85,
F95, F1900, F2100, LF45
SERIES TRUCKS



DOUBLE KIT# 200.221
OEM# 0681706, 0683405

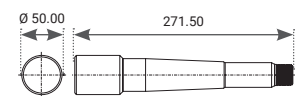

200.222.00

KING PIN REPAIR KIT

OEM #
0681702S
APPLICATION
DAF 75CF, 85CF, 95XF
SERIES TRUCKS



DOUBLE KIT# 200.222
OEM# 0681702, 0683392

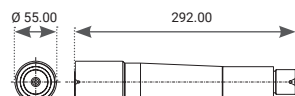

200.223.00

KING PIN REPAIR KIT

OEM #
0683470
1895526
APPLICATION
DAF 85CF, CF75, CF85,
XF95, XF105 SERIES
TRUCKS



DOUBLE KIT# 200.223
OEM# 0683470, 1895526



200.1026.00

KING PIN REPAIR KIT

OEM #
2022711
APPLICATION
DAF CF E6, CF F7, XF
E6, XF F7, XF G2, XG G3
SERIES TRUCKS



DOUBLE KIT# 200.1026
OEM# 2022711S

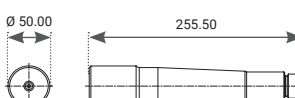

710.013.00

KING PIN REPAIR KIT

OEM #
04431-87303-T
APPLICATION
DAIHATSU DELTA
TRUCKS



DOUBLE KIT# 710.013
OEM# 04431-87303-TS

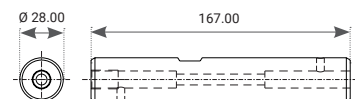



190.048.00 KING PIN REPAIR KIT

OEM #
04043-2053

APPLICATION
HINO 700 SERIES TRUCKS

DOUBLE KIT# 190.048
OEM# 04043-2053S

325.011.00 KING PIN REPAIR KIT

OEM #
K56771-62001

APPLICATION
HYUNDAI HD120 AERO TOWN SERIES BUS

DOUBLE KIT# 325.011
OEM# K56771-62001

325.012.00 KING PIN REPAIR KIT

OEM #
NYK-507

APPLICATION
HYUNDAI HD500 TRAGO SERIES VAN-UNIBUS

DOUBLE KIT# 325.012
OEM# NYK-507

520.035 KING PIN REPAIR KIT

OEM #
5878305360
5878309780
KP231

APPLICATION
ISUZU NKR, NPR 4JB1, JAC HFC6700, HFC1061, HFC1048, HFC1032 SERIES & ELF LIGHT TRUCKS

SINGLE KIT# 520.035.00

520.079 KING PIN REPAIR KIT

OEM #
APPLICATION
ISUZU TRUCKS

SINGLE KIT# 520.079.00

700.604.00 KING PIN REPAIR KIT

OEM #
01904696
500041676

APPLICATION
IVECO EURO CARGO I, EURO FIRE SERIES TRUCKS, EUROPOLIS, DOMINO SERIES BUS

DOUBLE KIT# 700.604
OEM# 01904696S1

700.605.00 KING PIN REPAIR KIT

OEM #
01904697

APPLICATION
IVECO EUROCARGO,
EUROFIRE SERIES
TRUCKS, MIDIRIDER
SERIES BUS



DOUBLE KIT# 700.605
OEM# 01904697S1

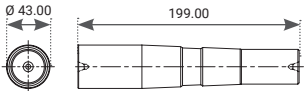

700.606.00 KING PIN REPAIR KIT

OEM #
002992185
01904698

APPLICATION
IVECO EUROCARGO,
EUROSTAR, EUROTECH,
EUROTRAKKER,
EUROMOVER, AT
STRALIS SERIES TRUCKS,
EUROPOLIS
SERIES BUS

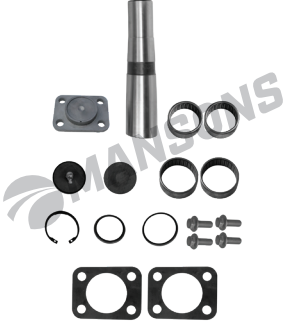

DOUBLE KIT# 700.606
OEM# 01904698S1, 02992185S1

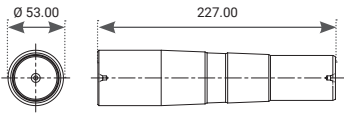

700.648.00 KING PIN REPAIR KIT

OEM #
42471014

APPLICATION
IVECO EUROCARGO I,
EUROSTAR, EUROTECH
SERIES TRUCKS



DOUBLE KIT# 700.648
OEM# 42471014S



EURO 6

400.575.00 KING PIN REPAIR KIT

OEM #
81.44205.6030
81.44205.6037

APPLICATION
MAN F2000, TGA,
TGM, TGS, TGX SERIES
TRUCKS & NG, NL, NM,
NU, SU, HOCL, LION
SERIES BUS



DOUBLE KIT# 400.575
OEM# 81.44205.6030
81.44205.6037



EURO 6

400.581.00 KING PIN REPAIR KIT

OEM #
81.36305.0015S1

APPLICATION
MAN F/M/L 2000, F/M
90, F 7/8/9, TGA, TGM,
TGS SERIES TRUCKS



DOUBLE KIT# 400.581
OEM# 81.36305.0015S



EURO 6

400.582.00 KING PIN REPAIR KIT

OEM #
81.36305.0014S
81.36305.0016S
81.36305.0016S

APPLICATION
MAN M/F90, F 7/8/9, M/F
2000, TGA, TGM, TGS
SERIES TRUCKS



DOUBLE KIT# 400.582
OEM# 81.36305.0014S2,
81.36305.0016S2



EURO 6

400.583.00 KING PIN REPAIR KIT

OEM #
81.44205.6013

APPLICATION
MAN F2000, L2000,
M2000, F90, M90, F 7/8/9
SERIES TRUCKS & MAN
EL, SG, SL, SU, UL, NG, NL,
NK, NM, LION'S CLASSIC
SERIES BUS

DOUBLE KIT# 400.583
OEM# 81.44205.6013

400.608.00 KING PIN REPAIR KIT

OEM #
24240049

APPLICATION
MAN OPTARE, SOLO,
SOLO SR SERIES BUS

DOUBLE KIT# 400.608
OEM# 24240049S1

400.610.00 KING PIN REPAIR KIT

OEM #
81.44205.6016

APPLICATION
MAN G90 SERIES
TRUCKS

DOUBLE KIT# 400.610
OEM# 81.44205.6016S1

400.611.00 KING PIN REPAIR KIT

OEM #
81.44205.6020

APPLICATION
MAN L2000, M2000
SERIES TRUCKS

DOUBLE KIT# 400.611
OEM# 81.44205.6020S1

400.612.00 KING PIN REPAIR KIT

OEM #
81.44205.6027

APPLICATION
MAN F2000, M2000
SERIES TRUCKS, SR, NL
SERIES BUS

DOUBLE KIT# 400.612
OEM# 81.44205.6027S1

400.613.00 KING PIN REPAIR KIT

OEM #
81.44205.6018

APPLICATION
MAN M2000, M90 SERIES
TRUCKS & EM, HOCL
SERIES BUS

DOUBLE KIT# 400.613
OEM# 81.44205.6018S1

400.614.00

KING PIN REPAIR KIT

OEM #
81.44205.6033
81.44205.6049

APPLICATION
MAN L2000, M2000, TGL,
TGM SERIES TRUCKS



DOUBLE KIT# **400.614**
OEM# 81.44205.6033S1
81.44205.6049S1

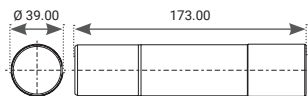

400.615.00

KING PIN REPAIR KIT

OEM #
81.44205.6023
81.44205.6029

APPLICATION
MAN F2000, M2000
SERIES TRUCKS, MAN
LION, NG, NL, NU, UL
SERIES BUS



DOUBLE KIT# **400.615**
OEM# 81.44205.6023S1
81.44205.6029S1

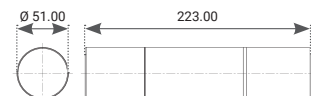

400.651.00

KING PIN REPAIR KIT

OEM #
81.44205.6034

APPLICATION
MAN TGM SERIES
TRUCKS



DOUBLE KIT# **400.651**
OEM# 81442056034

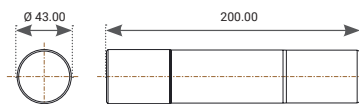

400.581.00

KING PIN REPAIR KIT

OEM #
3463300019
3465860033

APPLICATION
MERCEDES LK/LN2, NG,
SK, ACTROS, ACTROS 2,
AROCS, AXOR, AXOR 2
SERIES TRUCKS



DOUBLE KIT# **400.581**
OEM# 3463300019S
3465860033S

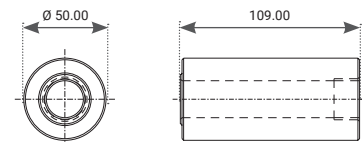

400.582.00

KING PIN REPAIR KIT

OEM #
3463300119
3465860133

APPLICATION
MERCEDES ACTROS,
ACTROS MP2/MP3,
AXOR, SK, NG SERIES
TRUCKS



DOUBLE KIT# **400.582**
OEM# 3463300119S1
3465860133S1

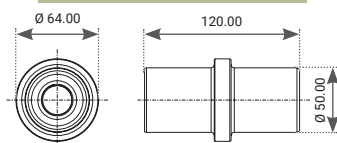

700.056.00

KING PIN REPAIR KIT

OEM #
3913300019
3915860033

APPLICATION
MERCEDES SK, MK, NG,
OF, L SERIES TRUCKS & O
SERIES BUS



DOUBLE KIT# **700.056**
OEM# 3913300019S1
3915860033S1

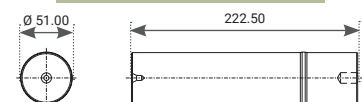

700.218.00

KING PIN REPAIR KIT

OEM #

6553300419S1

APPLICATION

MERCEDES ACTROS,
ATEGO, AXOR SERIES
TRUCKS



DOUBLE KIT# 700.218
OEM# 6553300419S2

700.248.00

KING PIN REPAIR KIT

OEM #

3895860033

3913300019

3915860033

APPLICATION

MERCEDES SK, MK, NG,
OF, L SERIES TRUCKS & O
SERIES BUS



DOUBLE KIT# 700.248
OEM# 3895860033S2, 3913300019S2
3915860033S2

700.281.00

KING PIN REPAIR KIT

OEM #

9423320806S

APPLICATION

MERCEDES ATEGO,
AXOR, ACTROS SERIES
TRUCKS



DOUBLE KIT# 700.281
OEM# 9423320806S1

NEW

700.437.00

KING PIN REPAIR KIT

OEM #

0003301719S

A0003301719S

APPLICATION

MERCEDES AROCS,
ANTOS, ATEGO, ACTROS
MP4, ECONIC, LK, LP, MK,
NG, SK SERIES TRUCKS



DOUBLE KIT# 700.437
OEM# 0003301719S1
A0003301719S1

NEW

700.780.00

KING PIN REPAIR KIT

OEM #

3463300219

3463320306

APPLICATION

MERCEDES ACTROS,
ACTROS MP2/MP3,
AROCS, AXOR, SK, NG
SERIES TRUCKS

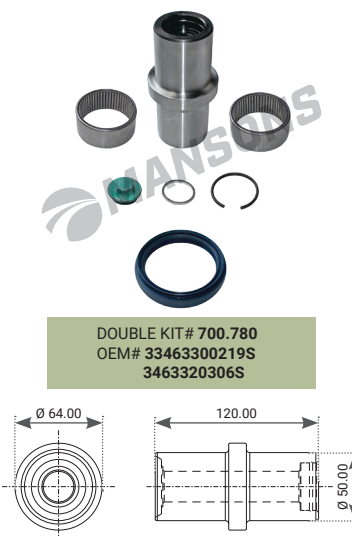

DOUBLE KIT# 700.780
OEM# 33463300219S
3463320306S

NEW

EURO 6

700.781.00

KING PIN REPAIR KIT

OEM #

3103301219

6683300019

APPLICATION

MERCEDES LK/LN2
SERIES TRUCKS



DOUBLE KIT# 700.781
OEM# 3103301219S
6683300019S

700.782.00 KING PIN REPAIR KIT

OEM #
6703300119
6753300119

APPLICATION
MERCEDES L, OF SERIES TRUCKS



DOUBLE KIT# 700.782
OEM# 6703300119S
6753300119S

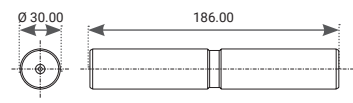

EURO 6

700.783.00 KING PIN REPAIR KIT

OEM #
6753300219
6753301419

APPLICATION
MERCEDES L SERIES TRUCKS & O SERIES BUS



DOUBLE KIT# 700.783
OEM# 6753301419S
6753300219S

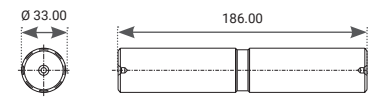

700.784.00 KING PIN REPAIR KIT

OEM #
6753300319
6753301519

APPLICATION
MERCEDES L SERIES TRUCKS & O SERIES BUS



DOUBLE KIT# 700.784
OEM# 6753300319S, 6753301519S

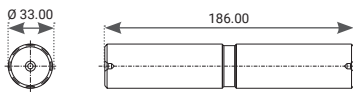

700.785.00 KING PIN REPAIR KIT

OEM #
6553300419

APPLICATION
MERCEDES ACTROS, ATEGO, AXOR SERIES TRUCKS



DOUBLE KIT# 700.785
OEM# 6553300419S

700.790.00 KING PIN REPAIR KIT

OEM #
6113300019

APPLICATION
MERCEDES L SERIES TRUCKS, O SERIES BUS



DOUBLE KIT# 700.790
OEM# 6113300019S



NEW

700.791.00 KING PIN REPAIR KIT

OEM #
6113300419

APPLICATION
MERCEDES L SERIES TRUCKS



DOUBLE KIT# 700.791
OEM# 6113300419S1



NEW

700.793.00

KING PIN REPAIR KIT

OEM #

3103300019
3103300519
3105860333

APPLICATION

MERCEDES L SERIES
TRUCKS



DOUBLE KIT# 700.793
OEM# 3103300019S
3103300519S
3105860333S

NEW

700.1211.00

KING PIN REPAIR KIT

OEM #

6553300519S

APPLICATION

MERCEDES ACTROS,
AXOR 2, ATEGO SERIES
TRUCKS



DOUBLE KIT# 700.1211
OEM# 6553300519S1

NEW

700.1212.00

KING PIN REPAIR KIT

OEM #

6553300519

APPLICATION

MERCEDES ACTROS,
AXOR 2, ATEGO SERIES
TRUCKS



DOUBLE KIT# 700.1212
OEM# 6553300519S

NEW

700.1213.00

KING PIN REPAIR KIT

OEM #

655 330 0719 S

APPLICATION

MERCEDES ACTROS,
ATEGO, AXOR, ECONIC
SERIES TRUCKS,
CONECTO SERIES BUS



DOUBLE KIT# 700.1213
OEM# 655 330 0719 S1

NEW

700.1214.00

KING PIN REPAIR KIT

OEM #

655 330 0719

APPLICATION

MERCEDES ACTROS,
ATEGO, AXOR, ECONIC
SERIES TRUCKS,
CONECTO SERIES BUS



DOUBLE KIT# 700.1214
OEM# 655 330 0719S2

NEW

710.013.00

KING PIN REPAIR KIT

OEM #

KP706B

APPLICATION

MITSUBISHI FUSO
CANTER TRUCKS



DOUBLE KIT# 710.013
OEM# KP706BS

800.072.00

KING PIN REPAIR KIT

OEM #
5000545970S
5010630992S
APPLICATION
RENAULT MIDLUM DXI,
MIDLINER, J SERIES
TRUCKS



DOUBLE KIT# **800.072**
OEM# **5000545970S1**
5000545970S1

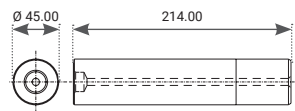

800.080.00

KING PIN REPAIR KIT

OEM #
5010216742
5010630993S
7420865913
7422536158
7482077738

APPLICATION
RENAULT MAGNUM,
MIDLUM, PREMIUM,
MIDLINER SERIES
TRUCKS



DOUBLE KIT# **800.080**
OEM# **5010216742S1, 5010630993S1**
7420865913S1, 7422536158S1
7482077738S1

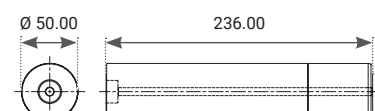

800.082.00

KING PIN REPAIR KIT

OEM #
5000793641
APPLICATION
RENAULT MIDLINER, J
SERIES TRUCKS



DOUBLE KIT# **800.082**
OEM# **5000793641S**

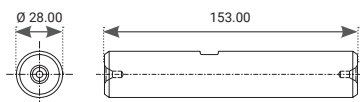

800.097.00

KING PIN REPAIR KIT

OEM #
7420590486S1
APPLICATION
RENAULT KERAX,
MAGNUM, PREMIUM
SERIES TRUCKS



DOUBLE KIT# **800.097**
OEM# **7420590486S2**

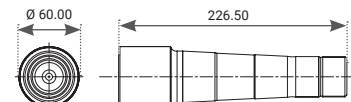

800.108.00

KING PIN REPAIR KIT

OEM #
7420865911
7422536144
APPLICATION
RENAULT MIDLUM
SERIES TRUCKS



DOUBLE KIT# **800.108**
OEM# **7420865911S1,**
7422536144S1

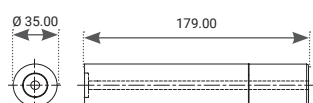

800.109.00

KING PIN REPAIR KIT

OEM #
7421356463
7421944970
APPLICATION
RENAULT MIDLUM
SERIES TRUCKS



DOUBLE KIT# **800.109**
OEM# **7421356463S1**
7421944970S1

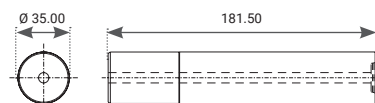

800.110.00

KING PIN REPAIR KIT

OEM

5000794185

APPLICATION

RENAULT MIDLINER
SERIES TRUCKS



800.111.00

KING PIN REPAIR KIT

OEM

5010056002S

5010630994S

7485135013

APPLICATION

RENAULT G, KERAX,
MAGNUM, PREMIUM2, R
SERIES TRUCKS



800.118.00

KING PIN REPAIR KIT

OEM

5000336306

APPLICATION

RENAULT J, MIDLINER
SERIES TRUCKS



800.121.00

KING PIN REPAIR KIT

OEM

5000793358

APPLICATION

RENAULT MIDLINER, J
SERIES TRUCKS



900.035.00

KING PIN REPAIR KIT

OEM

7421768314

APPLICATION

RENAULT C, D, K, T,
KERAX, MAGNUM II,
PREMIUM, PREMIUM II
SERIES TRUCKS



900.388.00

KING PIN REPAIR KIT

OEM

7421356465

7421944973

7482077724

APPLICATION

RENAULT MIDLUM
SERIES TRUCKS



900.488.00 KING PIN REPAIR KIT

OEM #
7420865912
7421356465
7421944973
7482077724

APPLICATION
RENAULT MIDLUM
SERIES TRUCKS



DOUBLE KIT# 900.488
OEM# 7420865912S1, 7421356465S1
7421944973S1, 7482077724S1



NEW

22.200.001.00 KING PIN REPAIR KIT

OEM #
5000793139

APPLICATION
RENAULT G170/260/290,
GB/TB191/231, GB131/
HR15 SERIES TRUCKS



DOUBLE KIT# 22.200.001
OEM# 5000793139S1

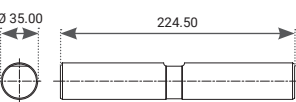

100.068.00 KING PIN REPAIR KIT

OEM #
0550729
0550730
550729
550730

APPLICATION
SCANIA 3 SERIES
TRUCKS & 3 SERIES BUS



DOUBLE KIT# 100.068



100.530.00 KING PIN REPAIR KIT

OEM #
1348296S
1403808S
550257
550284

APPLICATION
SCANIA P, G, R, T, 3, 4
SERIES TRUCKS & 4, F, K,
N SERIES BUS



DOUBLE KIT# 100.530



EURO 6

800.104.00 KING PIN REPAIR KIT

OEM #
85108338

APPLICATION
VOLVO FM9, FM12
SERIES AXLES



DOUBLE KIT# 800.104
OEM# 85108338S



EURO 6

800.108.00 KING PIN REPAIR KIT

OEM #
20865911
22536144

APPLICATION
VOLVO FL SERIES
TRUCKS



DOUBLE KIT# 800.108
OEM# 20865911S1, 22536144S1

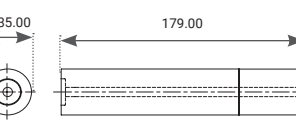



800.080.00

KING PIN REPAIR KIT

OEM #
20865913
22536158
82077738
APPLICATION
VOLVO FE, FL SERIES
TRUCKS

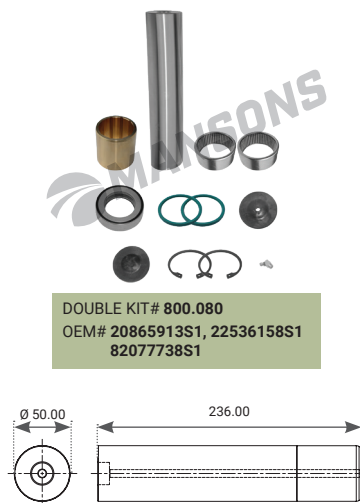

800.097.00

KING PIN REPAIR KIT

OEM #
20390834S1
85108338S1
APPLICATION
VOLVO FH12, FH16, FM7,
FM9, FM10, FM12, FL6,
NH12 SERIES TRUCKS,
VM USA SERIES TRUCKS



900.035.00

KING PIN REPAIR KIT

OEM #
20751021
APPLICATION
VOLVO FH12, FH16,
FM12, FM9, FL6, FMX,
NH12 SERIES TRUCKS,
B12, B9, B7 SERIES BUS



900.037.00

KING PIN REPAIR KIT

OEM #
270912, 271142
276023, 276031
3090266
APPLICATION
VOLVO FH16, F16, FL10,
FL12, FL6, FL7, FM10,
FM12, FM7, FS7, F10, F12,
F16, N10, NH12 SERIES
TRUCKS, B12 SERIES
BUS

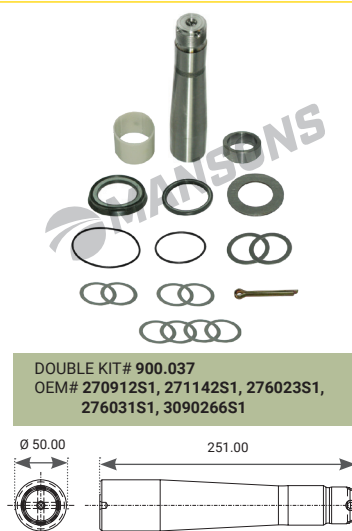

900.039.00

KING PIN REPAIR KIT

OEM #
3093731
3173757
APPLICATION
VOLVO FH12, FH16,
FL6, FM10, FM12, FM7,
FM9, FL6, NH12 SERIES
TRUCKS, B12, B9, B7
SERIES BUS

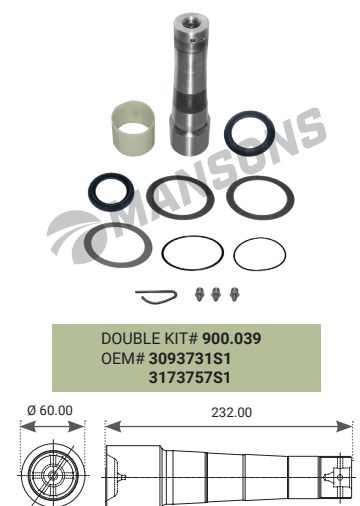

900.241.00

KING PIN REPAIR KIT

OEM #
3093731
3173757S
APPLICATION
VOLVO FH12, FH16,
FL6, FM10, FM12, FM7,
FM9, FL6, NH12 SERIES
TRUCKS, B12, B9, B7
SERIES BUS



900.070

KING PIN REPAIR KIT

OEM #
276033
276193

APPLICATION
VOLVO FL6, FE7, FE6,
SERIES TRUCKS & B6
SERIES BUS



DOUBLE KIT# 900.199
OEM# 276033S1, 276193S1

900.388.00

KING PIN REPAIR KIT

OEM #
21944973
82077724

APPLICATION
VOLVO FL SERIES
TRUCKS



DOUBLE KIT# 900.388
OEM# 21944973S1

900.488.00

KING PIN REPAIR KIT

OEM #
20865912
21356465
21944973
82077724

APPLICATION
VOLVO FL SERIES
TRUCKS



DOUBLE KIT# 900.488
OEM# 20865912S1, 21356465S1,
21944973S1, 82077724S1

900.531.00

KING PIN REPAIR KIT

OEM #
270920
2709202

APPLICATION
VOLVO FL6, FLC SERIES
TRUCKS



DOUBLE KIT# 900.531
OEM# 270920S1, 270920S1

900.532.00

KING PIN REPAIR KIT

OEM #
270911, 271141
276015, 276024
276030, 276032
3090267, 30902670
6889606

APPLICATION
VOLVO F10, F12, F16, F7,
FL10, FL12, FL6, FL7, FS7,
N7, N10, N12, NL10, NL12
SERIES TRUCKS, B7, B10,
B12 SERIES BUS

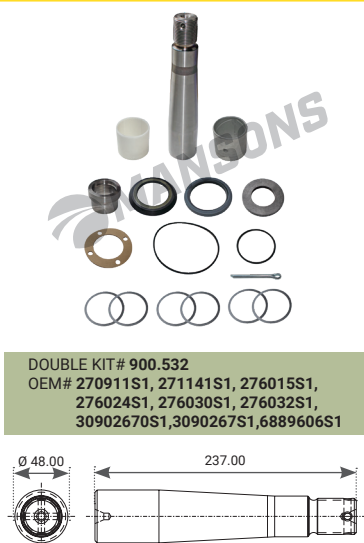

DOUBLE KIT# 900.532
OEM# 270911S1, 271141S1, 276015S1,
276024S1, 276030S1, 276032S1,
30902670S1, 3090267S1, 6889606S1

900.824.00

KING PIN REPAIR KIT

OEM #
270912S1, 271142S1
276023S1, 276031S1
3090266S1

APPLICATION
VOLVO FH12, FH16, FL6,
FL7, FL10, FL12, FM10,
FM12, FM7, FS7, F10,
F12, F16, N10, N12, NH12,
NL10, NL12 SERIES
TRUCKS, B7, B10, B12
SERIES BUS



DOUBLE KIT# 900.824
OEM# 270912S2, 271142S2
276031S2, 3090266S2

300.213.00

KING PIN REPAIR KIT

OEM #
03.112.76.08.0S
03.240.08.01.0S
APPLICATION
BPW H-K-N, SH-SKH...LL
SERIES SELF STEERING
AXLES



DOUBLE KIT# 300.213
OEM# 03.112.76.08.0S1,03.240.08.01.0S1

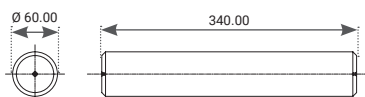

300.227.00

KING PIN REPAIR KIT

OEM #
03.112.76.08.0S
03.240.08.01.0S
APPLICATION
BPW H-K-N,
SH-SKH...LL SERIES SELF
STEERING AXLES



DOUBLE KIT# 300.227
OEM# 03.112.76.08.0S1,
03.240.08.01.0S1

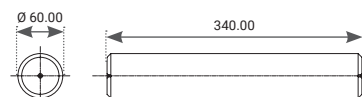

300.551.00

KING PIN REPAIR KIT

OEM #
09.801.02.35.0S
APPLICATION
BPW H-K-N, SH-SKH...LL
SERIES SELF STEERING
AXLES



DOUBLE KIT# 300.551
OEM# 09.801.02.35.0

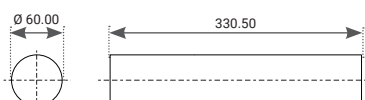

790.500.00

KING PIN REPAIR KIT

OEM #
AXLBF8-10
GF006010012A
APPLICATION
MERITOR TE SERIES
AXLES
STEFEN 8-10 TON SELF
STEERING AXLES, 1st
SERIES



DOUBLE KIT# 790.500
OEM# AXLBF8-10
GF006010012A

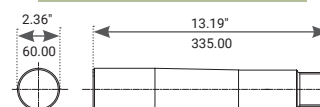

790.501.00

KING PIN REPAIR KIT

OEM #
AXLBF8-10
APPLICATION
MERITOR TE SERIES
AXLES
STEFEN (MERITOR) 8-10
TON SELF STEER AXLES,
2nd SERIES



DOUBLE KIT# 790.501
OEM# AXLBF8-10

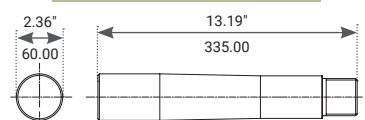



MANSONS #	CROSS REF #	CROSS REF #	CROSS REF #
200.037.00	--	--	--
200.068.00	SA8J0009	39130	050.606
200.069.00	--	--	050.610
200.121.00	5.92015	39120	050.568A
200.173.00	--	--	--
200.174.00	--	--	--
200.176.00	--	--	--
200.221.00	--	--	--
200.222.00	--	--	--
200.223.00	5.92014	104471	--
200.1026.00	5.92017	104083	050.630
710.013.00	--	--	--
190.048.00	--	--	--
325.011.00	--	--	--
325.012.00	--	--	--
520.035	--	--	--
520.079	--	--	--
700.604.00	--	18418	--
700.605.00	7.92002	18419	060.614
700.606.00	7.92000	18420	060.521
700.648.00	7.92009	40130	060.547
400.575.00	3.96211	19000	020.548
400.581.00	4.91112	05869	010.680A
400.582.00	4.91113	05875	010.681
400.583.00	3.96205	08521	020.518
400.608.00	--	--	--
400.610.00	3.96206	01254	020.520
400.611.00	3.96209	10608	020.540
400.612.00	--	24777	020.547
400.613.00	--	14573	020.528
400.614.00	3.96217	170123	020.567
400.615.00	3.96210	18999	020.533
400.651.00	3.96221	172052	020.565
400.581.00	4.91112	05869	010.680A
400.582.00	4.91113	05875	010.681
700.056.00	--	06015	010.655
700.218.00	4.91102	15905	010.720/2
700.248.00	--	--	--
700.281.00	4.91579	--	--
700.437.00	--	--	010.908/2
700.780.00	4.91114	15991	010.719
700.782.00	4.91266	08802	010.638
700.783.00	4.91269	08535	010.640
700.784.00	4.91573	08526	010.647
700.785.00	4.91101	15881	010.720
700.790.00	--	--	010.653

MANSONS #	CROSS REF #	CROSS REF #	CROSS REF #
700.791.00	--	--	--
700.793.00	--	06319	010.644
700.1211.00	4.91105	15906	010.721/2
700.1212.00	4.91104	15882	010.721
700.1213.00	4.91103	--	--
700.1214.00	4.90878	15884	010.724
700.781.00	--	--	010.667
710.013.00	--	--	--
800.072.00	--	--	080.611
800.080.00	6.94004	--	080.538
800.082.00	6.94017	--	080.533
800.097.00	2.95018	28585	030.576/1
800.108.00	6.94003	39440	080.729
800.109.00	--	--	080.701
800.110.00	6.94011	30281	080.607
800.111.00	6.94012	177686	080.726
800.118.00	6.94009	--	080.514
800.121.00	--	--	502.658
900.035.00	2.95020	40891	030.581
900.388.00	SA8J0010	--	080.727
900.488.00	SA8J0010	--	080.703
22.200.001.00	--	--	080.560
100.068.00	1.31602	05016	040.514
100.530.00	1.31603	09937	040.518
800.104.00	--	--	--
800.108.00	6.94003	39440	080.729
800.080.00	6.94004	--	080.538
800.097.00	2.95018	28585	030.576/1
900.035.00	2.95020	40891	030.581
900.037.00	2.95001	04541	030.510
900.039.00	2.95005	28584	030.558
900.241.00	2.95015	--	030.558/1
900.070	--	31103	030.513
900.388.00	SA8J0010	--	080.727
900.488.00	SA8J0010	--	080.703
900.531.00	2.95003	--	030.737
900.532.00	2.95002	03407	030.511
900.824.00	--	09375	030.510/2
300.213.00	--	--	--
300.227.00	--	--	--
300.551.00	--	--	--
790.500.00	--	--	--
790.501.00	--	--	--



NPA 1043 (Updated May 2024)

EUROPEAN TRUCK & TRAILER KING PIN REPAIR KITS
