

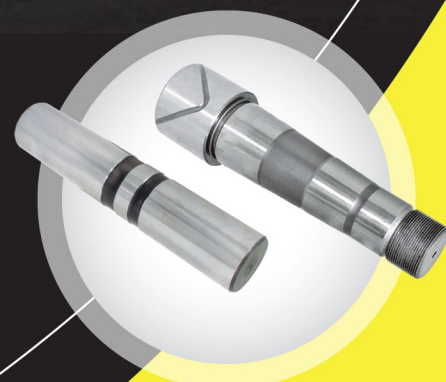

NPA 959

NORTH AMERICAN TRUCK & TRAILER KING PIN KITS



SUSPENSION



FIFTH WHEEL



BODY



AXLE



ANTI-VIBRATION



DRIVELINE



CABIN



STEERING



ENGINE & TRANSMISSION



EXHAUST





SR.#	BRANDS	PAGE
1	CHEVROLET	03-04
2	DAIHATSU	04-04
3	DANA	05-14
4	DENNIS	15-15
5	EATON	15-22
6	FORD	23-25
7	FREIGHTLINER	26-29
8	HENDRICKSON	29-30
9	GENERAL MOTORS	31-32
10	INTERNATIONAL NAVISTAR	33-40
11	KENWORTH	41-41
12	MACK	42-43
13	MERITOR	44-55
14	MITSUBISHI	56-56
15	SAF HOLLAND	56-56
16	VOLVO	57-59
17	WATSON & CHALIN	59-59

- **17 Brands**
- **58 References**
- **29 Bi-Metal Bush Kits**
- **13 Composite Bush Kits**
- **10 No Ream Bush Kits**
- **1 Nylon/ Brass Bush Kit**

FEATURES & BENEFITS

- Designed for all popular truck applications
- OEM equivalent materials grade to meet service life expectations
- 2 years warranty
- Steel bushes & pins are grooved for optimum lubrication
- Fits most axle applications including: Chevrolet, Dana, Eaton, Spicer, Ford, GMC, International Navistar, Mack, Meritor & Volvo



360.010

KING PIN REPAIR KIT

OEM #
2036352

APPLICATION

CHEVROLET/GM N9E,
N9F, J8C, J9C, D90,
D9500, J70, J7500,
J90, J9500, M90,
M9500, D9K, D9L
SERIES 16000,18000
LB AXLES

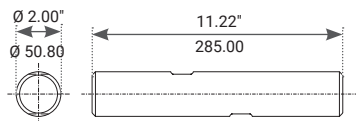

360.010PR

KING PIN REPAIR KIT

OEM #
203652

APPLICATION

CHEVROLET/GM N9E,
N9F, J8C, J9C, D90,
D9500, J70, J7500,
J90, J9500, M90,
M9500, D9K, D9L
SERIES 16000,18000
LB AXLES

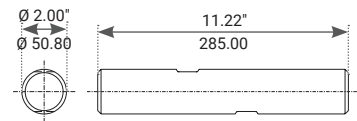

580.014

KING PIN REPAIR KIT

OEM #
85106184S1

APPLICATION

CHEVROLET AXLES

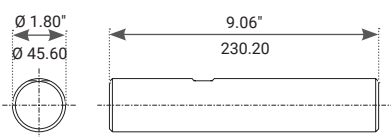

740.001

KING PIN REPAIR KIT

OEM #
2010021

APPLICATION

GMC/CHEVROLET
N9E, N9F, S70, S7T,
S7500, TITAN, ASTRO,
D9K, D9L SERIES
FF931, FG943, FF941
MODEL AXLES

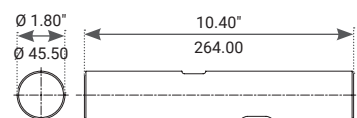

780.578

KING PIN REPAIR KIT

OEM #
12540329
APPLICATION
CHEVROLET AXLES

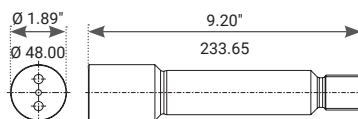

710.013

KING PIN REPAIR KIT

OEM #
04431-87303-TS
APPLICATION
DAIHATSU DELTA
TRUCKS

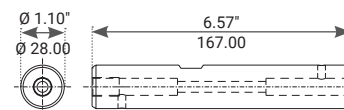

270.001

KING PIN REPAIR KIT

OEM #
328347

APPLICATION

EATON/ DANA/
SPICER E-11462I,
E-1462W, E-13222I,
1322W, E-1202I,
E-1002I, 1002W
SERIES AXLES

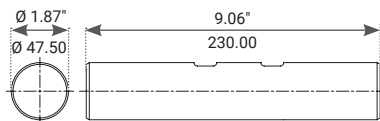

270.001PR

KING PIN REPAIR KIT

OEM #
328349

APPLICATION

EATON/ DANA/
SPICER E-11462I,
E-1462W, E-13222I,
1322W, E-1202I,
E-1002I, 1002W
SERIES AXLES

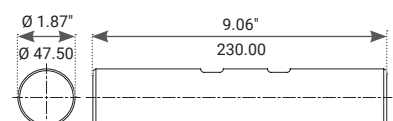

270.033

KING PIN REPAIR KIT

OEM #
KPK3002

APPLICATION

EATON / DANA /
SPICER E1202I/W,
E1322I/W, E1462I/W
SERIES AXLES

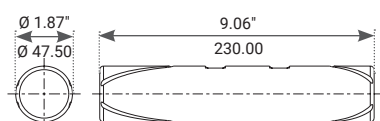

360.012

KING PIN REPAIR KIT

OEM #
KPK1165

APPLICATION

DANA

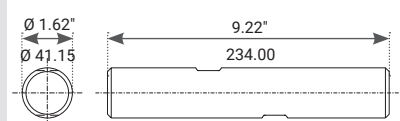

Technical drawing of a 1/2" NPT x 10' pipe. The drawing shows a cross-section of the pipe with a diameter of 1.79" and a wall thickness of 0.4546". The length of the pipe is 10.10' (256.50").

Technical drawing of a pipe section. The drawing shows a cross-section of the pipe with a diameter of 1.05 inches and a wall thickness of 0.2670 inches. The length of the pipe is indicated as 7.00 feet (178.00 inches).

KING PIN REPAIR KIT

A collection of various mechanical components including shafts, couplings, flanges, and fasteners. The components are arranged in a grid-like fashion. There are two long vertical shafts with a black band near the top. Below them are four shorter vertical shafts. In the center are two circular flanges with a central hole. To the right of the flanges are four O-rings. Below the flanges are three yellow couplings. To the left of the couplings are three light blue O-rings. To the right of the couplings are two black shafts with a central hole. Below the shafts are three small circular flanges. At the bottom are three light blue O-rings and a collection of small fasteners including screws and bolts.

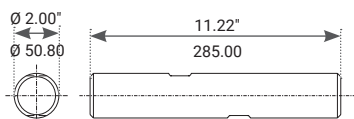

KING PIN REPAIR KIT

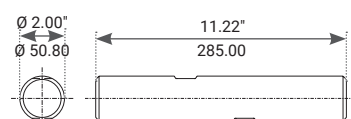

KING PIN REPAIR KIT

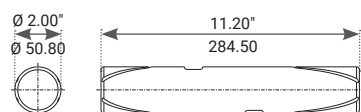

KING PIN REPAIR KIT

A collection of various mechanical components including shafts, couplings, and fasteners. The components are arranged in a grid-like fashion. There are two long, polished metal shafts at the top. Below them are four shorter, polished metal shafts. In the middle row, there are two black rubber couplings and four black metal couplings. The bottom row features two black metal couplings, two black metal couplings, and two black metal couplings. At the very bottom, there are two black metal couplings, two black metal couplings, and two black metal couplings.

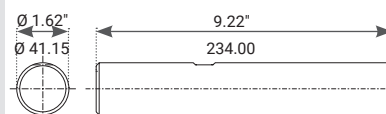

560.007

KING PIN REPAIR KIT

OEM #
262-1569
APPLICATION
DANA AXLES

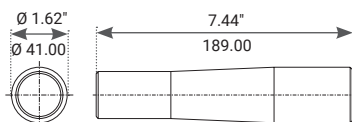

560.008

KING PIN REPAIR KIT

OEM #
262-1591
APPLICATION
DANA AXLES

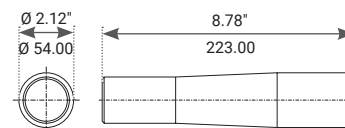

560.244

KING PIN REPAIR KIT

OEM #
262-1591
APPLICATION
DANA AXLES

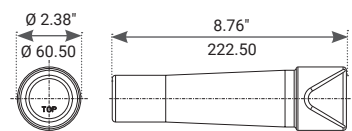

580.012

KING PIN REPAIR KIT

OEM #
262-1491
APPLICATION
DANA AXLES

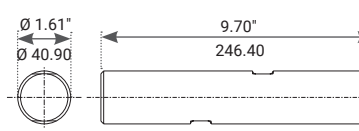

580.012PR

KING PIN REPAIR KIT

OEM #
343KK103

APPLICATION

EATON / DANA I-108
EXCEPT CODE 02309,
I-120 EXCEPT CODE
02309, I-132 SERIES
AXLES

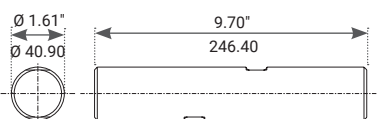

580.013

KING PIN REPAIR KIT

OEM #
KPK1154

APPLICATION

DANA / EATON
02ADA, 02ADB,
02AEM BEFORE
10/2002 SERIES
AXLES

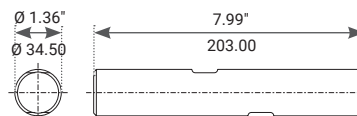

580.013PR

KING PIN REPAIR KIT

OEM #
101KK111

APPLICATION

EATON/ DANA
02ADA, 02ADB,
02AEM BEFORE
10/2002 SERIES
AXLES

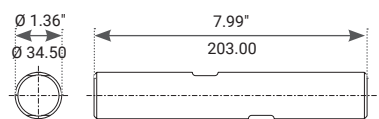

270.032

KING PIN REPAIR KIT

OEM #
KPK3005

APPLICATION

EATON / DANA
02ADA, 02ADB,
02AEM SERIES AXLES

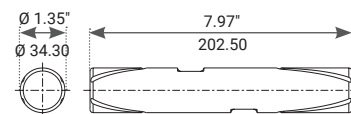

580.014

KING PIN REPAIR KIT

OEM #
328342

APPLICATION
DANA / EATON
E1000I, E1200I,
E1320I SERIES
MODEL AXLES

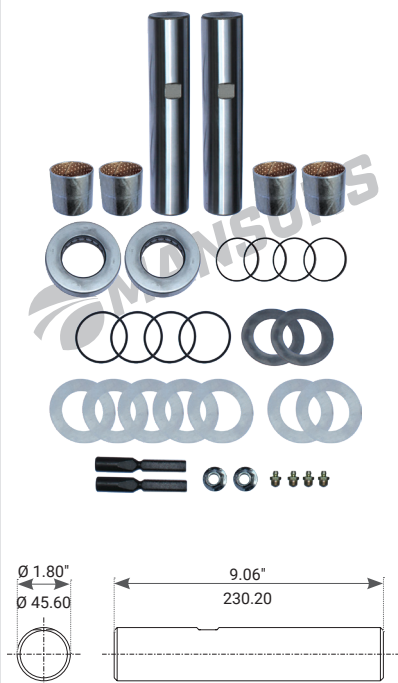

270.035

KING PIN REPAIR KIT

OEM #
KPK3011

APPLICATION
EATON/ DANA/
SPICER E1000I,
E1200I, E1320I
SERIES MODEL
AXLES



580.025

KING PIN REPAIR KIT

OEM #
2621635

APPLICATION
EATON / DANA
02ADD, 02ADG,
02ADN, 02ADP
SERIES AXLES

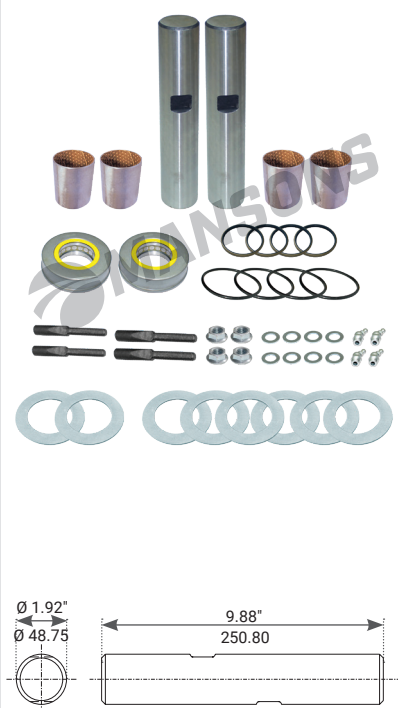

580.025PR

KING PIN REPAIR KIT

OEM #

APPLICATION
DANA AXLES

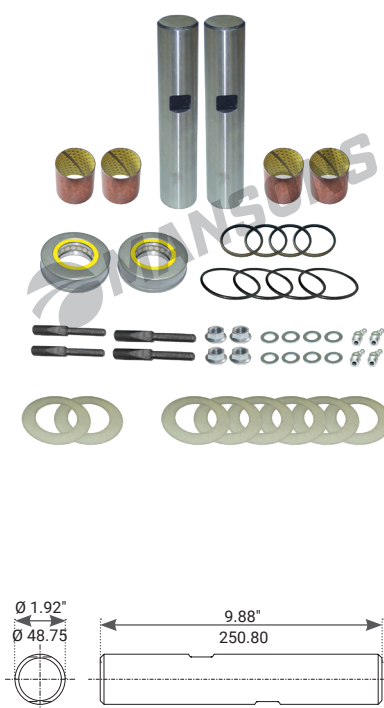

KING PIN REPAIR KIT

OEM #
262-1604

APPLICATION

DANA AXLES

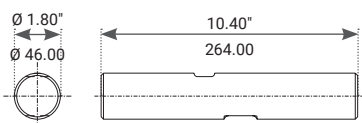

KING PIN REPAIR KIT

OEM #
2621636

APPLICATION
DANA / EATON
I-132SG, I-140SG,
I-140S, I-140W SERIES
AXLES

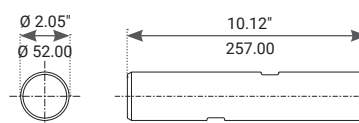

KING PIN REPAIR KIT

OEM #
10230/4

APPLICATION

DANA/SPICER AXLES

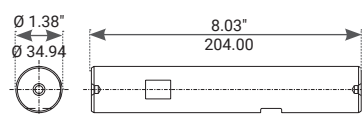

KING PIN REPAIR KIT

OEM #
262-1572

APPLICATION

DANA AXLES

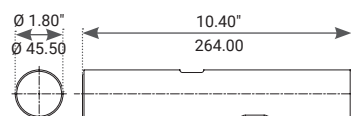

A collection of various mechanical components, including two long cylindrical rods, several smaller cylinders, various flanges and gaskets, and a set of bolts and washers.

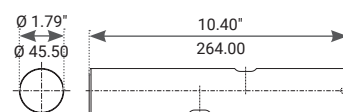
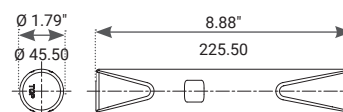
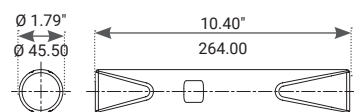
[illegible]

780.578

KING PIN REPAIR KIT

OEM #
262-1641
APPLICATION
DANA AXLES

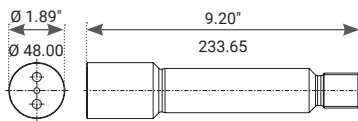

780.581

KING PIN REPAIR KIT

OEM #
KPK1049
APPLICATION
DANA AXLES

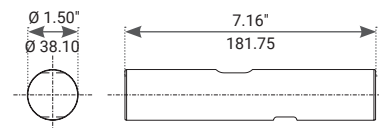

130.001

KING PIN REPAIR KIT

OEM #
329182
APPLICATION
EATON/DANA/
SPICER 02-AEM, 02-
AHA, 02-AGZ, 02-ADZ,
02-AGN, D600, D700,
D850, D800F SERIES
AXLES

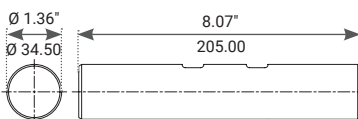

270.034

KING PIN REPAIR KIT

OEM #
KPK3004
APPLICATION
EATON / DANA /
SPICER D600, D700,
D850, D800F SERIES
AXLES

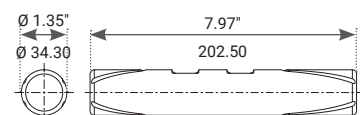

130.022 KING PIN REPAIR KIT

OEM #
328343

APPLICATION
SPICER/ EATON/
DANA 14600, E1460I/
W NEW SERIES
AFTER 2000

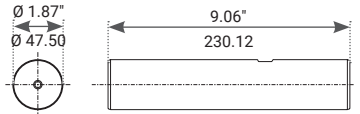
130.023 KING PIN REPAIR KIT

OEM #
2621636

APPLICATION
DANA I132SG, 140S/
SG, 02ADE, 02ADG
SERIES AXLES

130.023PR KING PIN REPAIR KIT

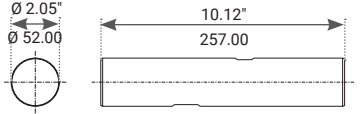
OEM #
2621636

APPLICATION
DANA I132SG, 140S/
SG, 02ADE, 02ADG
SERIES AXLES



270.031 KING PIN REPAIR KIT

OEM #
806355

APPLICATION
EATON / DANA
EFA12F4 SERIES
AXLES

NO REAM





575.003

KING PIN REPAIR KIT

OEM #
DEP102986

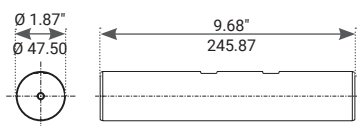
APPLICATION
DENNIS EAGLE
TRUCKS



730.001

KING PIN REPAIR KIT

OEM #
8226669-3

APPLICATION
DENNIS TRUCKS

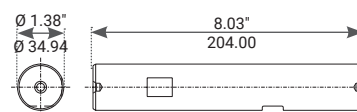

130.001

KING PIN REPAIR KIT

OEM #
329182

APPLICATION
EATON/ DANA/
SPICER 02-AEM, 02-
AHA, 02-AGZ, 02-ADZ,
02-AGN, D600, D700,
D850, D800F SERIES
AXLES

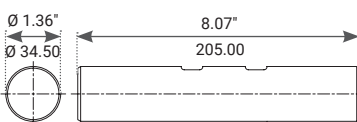

270.034

KING PIN REPAIR KIT

OEM #
KPK3004

APPLICATION
EATON / DANA /
SPICER D600, D700,
D850, D800F SERIES
AXLES

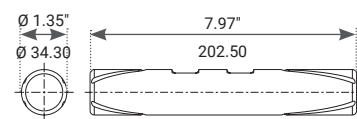

Technical drawing of a shaft with a keyway. The left view is a circular cross-section showing a diameter of 1.87 inches and a hole diameter of 0.4750 inches. The right view is a side view showing a total length of 9.06 inches and a keyway width of 230.12 mils.

Technical drawing of a circular hole. The hole has a diameter of 2.05 inches, indicated by a dimension line with arrows and the text $\varnothing 2.05''$. The hole is located 52.00 inches from the left edge of the part, indicated by a dimension line with arrows and the text $\varnothing 52.00$. The hole is also 10.12 inches from the top edge of the part, indicated by a dimension line with arrows and the text 10.12". The hole is 257.00 inches from the bottom edge of the part, indicated by a dimension line with arrows and the text 257.00.

270.001PR

KING PIN REPAIR KIT

OEM #
328349

APPLICATION
EATON/ DANA/
SPICER STEERING
AXLE E-11462I,
E-1462W, E-13222I,
1322W, E-1202I,
E-1002I, 1002W
SERIES AXLES

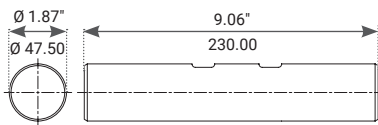

270.033

KING PIN REPAIR KIT

OEM #
KPK3002

APPLICATION
EATON/ DANA /
SPICER E1202I/ W,
E1322I/ W, E1462I/ W
SERIES AXLES

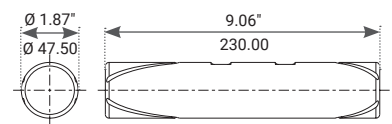

340.002

KING PIN REPAIR KIT

OEM #
KP2315

APPLICATION
EATON AXLES

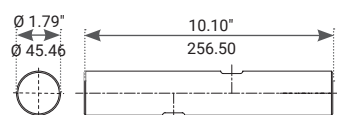

340.003

KING PIN REPAIR KIT

OEM #
KP2319

APPLICATION
EATON AXLES

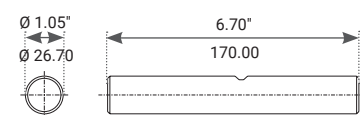

340.004

KING PIN REPAIR KIT

OEM #
KP2343
APPLICATION
EATON AXLES

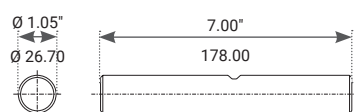

360.010

KING PIN REPAIR KIT

OEM #
KP2314
APPLICATION
EATON AXLES

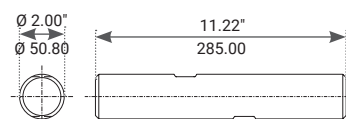

360.010PR

KING PIN REPAIR KIT

OEM #
KP2314
APPLICATION
EATON AXLES

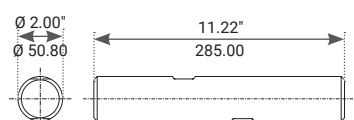

360.011

KING PIN REPAIR KIT

OEM #
1008431
806355
APPLICATION
EATON EFA12F4, EFA-13F5 CONVENTIONAL STEERING ARM SERIES AXLES

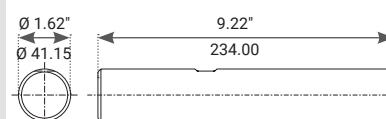

360.012

KING PIN REPAIR KIT

OEM #
1008431BM
806355BM
APPLICATION
EATON EFA12F4,
EFA-13F5
CONVENTIONAL
STEERING ARM
SERIES AXLES

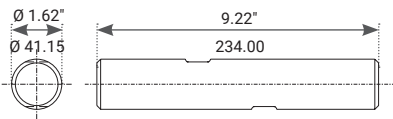

270.031

KING PIN REPAIR KIT

OEM #
806355
APPLICATION
EATON / DANA
EFA12F4 SERIES
AXLES

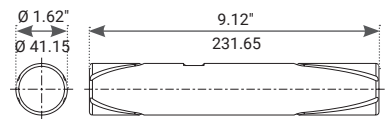

560.007

KING PIN REPAIR KIT

OEM #
KP2330
APPLICATION
EATON AXLES

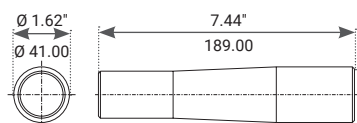

560.008

KING PIN REPAIR KIT

OEM #
KP2336
APPLICATION
EATON AXLES

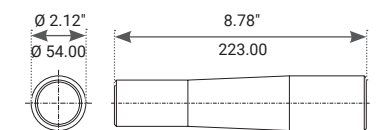

560.244

KING PIN REPAIR KIT

OEM #
KP2336

APPLICATION
EATON AXLES

**NO
REAM**

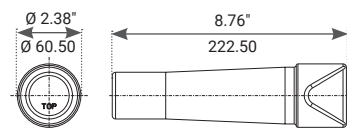

580.012

KING PIN REPAIR KIT

OEM #
KP2312

APPLICATION
EATON AXLES

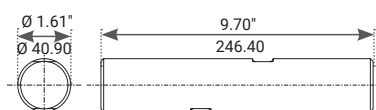

580.012PR

KING PIN REPAIR KIT

OEM #
343KK103

APPLICATION
EATON/ DANA I-108
EXCEPT CODE 02309,
I-120 EXCEPT CODE
02309, I-132 SERIES
AXLES

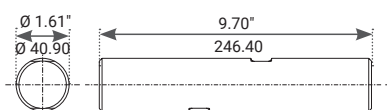

580.013

KING PIN REPAIR KIT

OEM #
KPK1154

APPLICATION
DANA/ EATON
02ADA, 02ADB,
02AEM BEFORE
10/2002 SERIES
AXLES

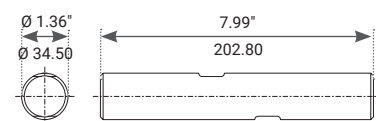

580.013PR

KING PIN REPAIR KIT

OEM #
101KK111

APPLICATION
EATON/ DANA
02ADA, 02ADB,
02AEM BEFORE
10/2002 SERIES
AXLES

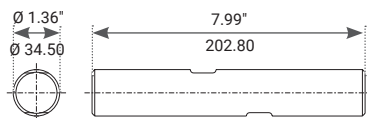

270.032

KING PIN REPAIR KIT

OEM #
KPK3005

APPLICATION
EATON/ DANA
02ADA, 02ADB,
02AEM SERIES AXLES

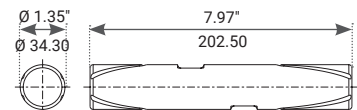

580.288

KING PIN REPAIR KIT

OEM #
2621636
329022

APPLICATION
DANA / EATON
I-132SG, I-140SG,
I-140S, I-140W SERIES
AXLES

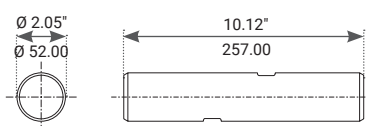

580.014

KING PIN REPAIR KIT

OEM #
328342
328344
823078

APPLICATION
EATON E1000I,
E1200I, E1320I
SERIES MODEL
AXLES

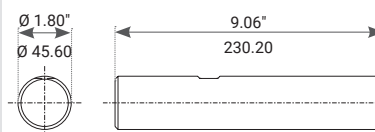



270.035

KING PIN REPAIR KIT

OEM #
KPK3011

APPLICATION
EATON/ DANA/
SPICER E1000I,
E1200I, E1320I
SERIES AXLES

NO
REAM

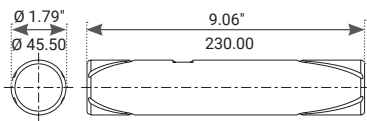

740.001

KING PIN REPAIR KIT

OEM #
KP2327

APPLICATION
EATON AXLES

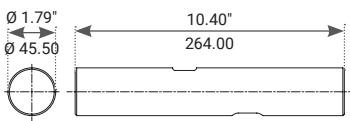

130.001

KING PIN REPAIR KIT

OEM #
4C4Z-3111-BB
APPLICATION
FORD AXLES

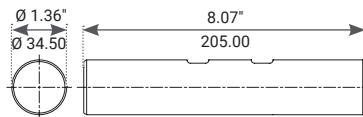

270.034

KING PIN REPAIR KIT

OEM #
4C4Z-3111-BB
APPLICATION
FORD F650, F750
SERIES AXLES

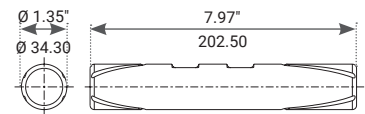

340.002

KING PIN REPAIR KIT

OEM #
D6HZ-3111-A
APPLICATION
FORD C/ CT/ CF600/
CF700, CF/ CFT800,
CL/ CLT900, CL/
CLT9000, F/ FT600, F/
FT6000, F/ FT700, F/
FT800, F880, F8000,
F/ FT900, F/ FT9000,
L900/ 9000, W/ WT900
AXLES

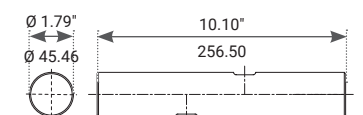

340.003

KING PIN REPAIR KIT

OEM #
D5TZ-3111-B
D5UZ-3111-B
APPLICATION
FORD E100/ 250/
350, F250/ 350
CONVENTIONAL 2
WHEEL DRIVE AXLES

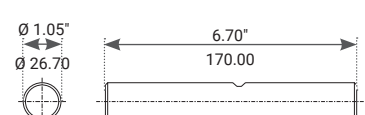

340.004

KING PIN REPAIR KIT

OEM #
E0TZ-3111-A
APPLICATION
FORD E100/250/
350, F250/350
CONVENTIONAL 2
WHEEL DRIVE AXLES

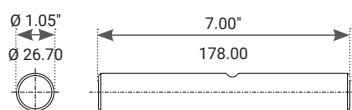

340.196

KING PIN REPAIR KIT

OEM #
1649994
6184797
81DB-3111-AB
APPLICATION
FORD CARGO 7.5 TON
KC AXLES

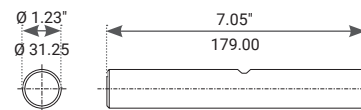

340.345

KING PIN REPAIR KIT

OEM #
E8TZ-3111-A
APPLICATION
FORD F450 SUPER
DUTY SERIES TRUCKS

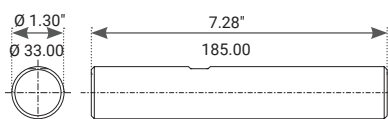

360.010

KING PIN REPAIR KIT

OEM #
D5HZ-3111-C
APPLICATION
FORD 800-850-880,
900-950 SERIES
TRUCKS

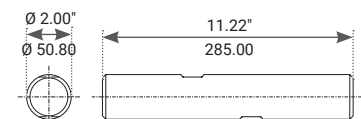

360.010PR

KING PIN REPAIR KIT

OEM #
D3HA-3010-AA

APPLICATION
FORD AT85 1996-
1998 (18-20,000#)
SERIES AXLES

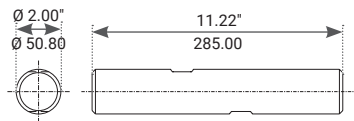

780.580

KING PIN REPAIR KIT

OEM #
E9HZ-3111-C

APPLICATION
FORD 600, 700, 750,
800, 850, 880, 900,
950 SERIES MODEL
AIR BRAKES AXLES

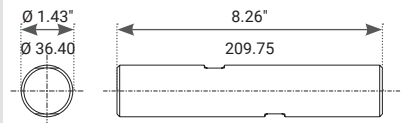

360.010

KING PIN REPAIR KIT

OEM

APPLICATION
FREIGHTLINER
CONVENTIONAL
FL931, FL933, FL941,
FL943, FL951 SERIES
TRUCKS

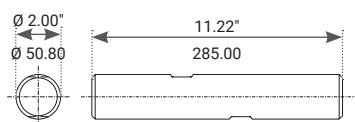

360.010PR

KING PIN REPAIR KIT

OEM

APPLICATION
FREIGHTLINER
CONVENTIONAL
FL931, FL933, FL941,
FL943, FL951 SERIES
TRUCKS

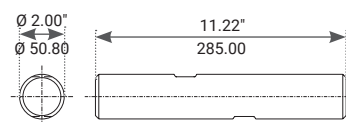

360.011

KING PIN REPAIR KIT

OEM

APPLICATION
FREIGHTLINER
EFA12F4 MODEL
AXLES, FLD, COE FLP,
FLT, CONVENTIONAL
FLC SERIES TRUCKS

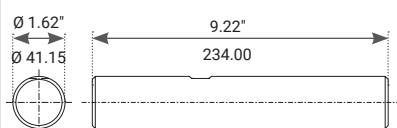

360.012

KING PIN REPAIR KIT

OEM

APPLICATION
FREIGHTLINER
FLD, COE FLP, FLT,
CONVENTIONAL FLC
SERIES TRUCKS

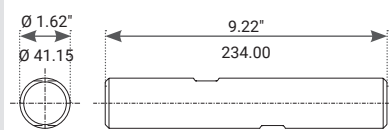

270.031

KING PIN REPAIR KIT

OEM #
FLTRLKP120E
APPLICATION
FREIGHTLINER AXLES

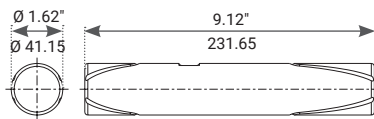

360.204

KING PIN REPAIR KIT

OEM #
TDAR201419
APPLICATION
FREIGHTLINER
CENTURY, CASCADIA,
AROGOSY SERIES
TRUCKS

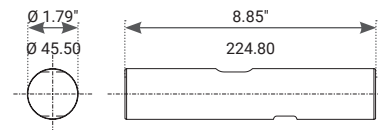

360.204PR

KING PIN REPAIR KIT

OEM #
TDAR201419
APPLICATION
FREIGHTLINER
CENTURY, CASCADIA,
AROGOSY SERIES
TRUCKS

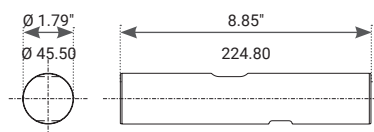

360.546

KING PIN REPAIR KIT

OEM #
607-330-00-19
607-330-00-19K
FL607-330-00-19
APPLICATION
FREIGHTLINER
TRUCKS

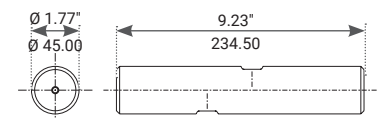

580.026

KING PIN REPAIR KIT

OEM

TDAR201315

APPLICATION

FREIGHTLINER FLD,
FLP, FLT, FLC, FL
SERIES TRUCKS,
FF942, FF961,
FL931, FF943 MODEL
AXLES

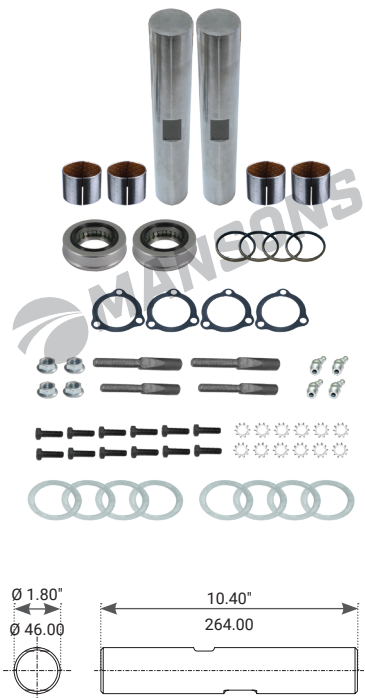

780.163

KING PIN REPAIR KIT

OEM

APPLICATION

FREIGHTLINER C112,
C120 CENTURY
CLASS, FLC120, FLP,
FLT SERIES TRUCKS

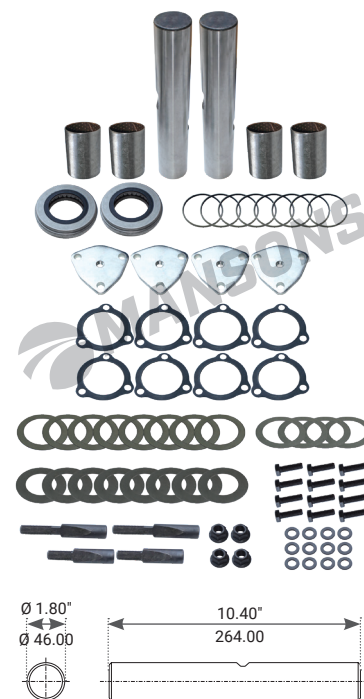

780.165

KING PIN REPAIR KIT

OEM

APPLICATION

FREIGHTLINER
CONVENTIONAL FLD,
FLC, FLP, FLT SERIES
TRUCKS

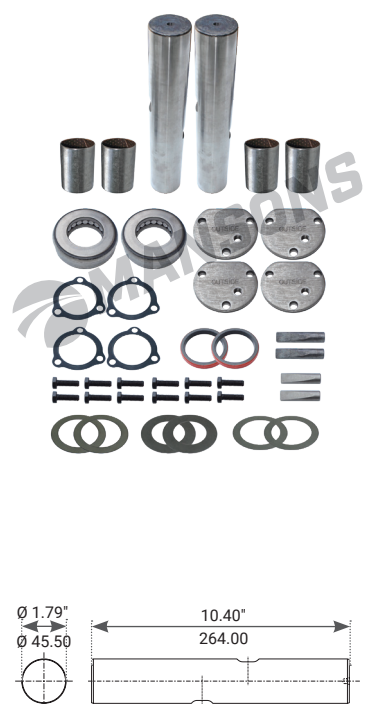

780.398

KING PIN REPAIR KIT

OEM

TDAR202011

APPLICATION

FREIGHTLINER AXLES



780.399

KING PIN REPAIR KIT

OEM #
TDAR202003
APPLICATION
FREIGHTLINER AXLES

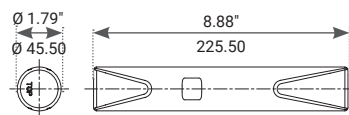

360.010

KING PIN REPAIR KIT

OEM #
R-001442
APPLICATION
HENDRICKSON
AXLES

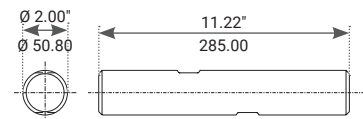

360.010PR

KING PIN REPAIR KIT

OEM #
R-001442
APPLICATION
HENDRICKSON
AXLES

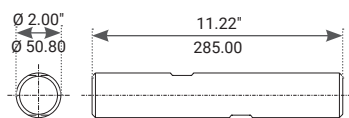

780.398

KING PIN REPAIR KIT

OEM #
APPLICATION
HENDRICKSON
AXLES

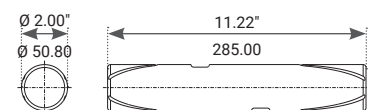



780.579

KING PIN REPAIR KIT

OEM #
R-003200

APPLICATION
HENDRICKSON HLP
PARALIFT HLUS - US2T,
HLUR2T - UR2T13,
UCL-UCLT, UC2, 3, 4 -
UC2, 3, 4T, FBC - FBT07
- FBT10 SERIES REAR
TAG AXLES

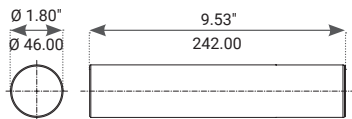

10.560

KING PIN REPAIR KIT

OEM #
60961-009
60961-040

APPLICATION
HENDRICKSON
AIRTEK, SOFTEK &
STEERTEK SERIES
FRONT STEER AXLES



740.001

KING PIN REPAIR KIT

OEM #
2010021

APPLICATION

GMC/CHEVROLET
N9E, N9F, S70, S7T,
S7500, TITAN, ASTRO,
D9K, D9L SERIES
FF931, FG943, FF941
MODEL AXLES

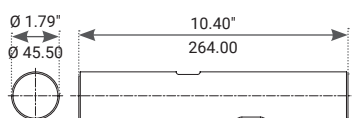

780.581

KING PIN REPAIR KIT

OEM #
88936119

APPLICATION

GENERAL MOTORS
KODIAK C SERIES
MODEL FM7 AXLES

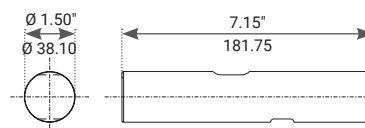

360.010

KING PIN REPAIR KIT

OEM #
15585841

APPLICATION

GENERAL MOTORS
D90, F90 SERIES
FL931 AXLES

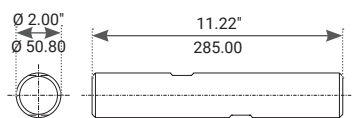

360.010PR

KING PIN REPAIR KIT

OEM #
15585841

APPLICATION

GENERAL MOTORS D90, F90 SERIES FL931 AXLES

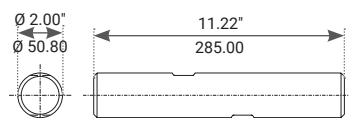

540.028

KING PIN REPAIR KIT

OEM #
88936044
APPLICATION
GENERAL MOTORS
AXLES

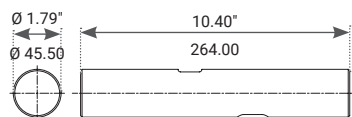

540.028PR

KING PIN REPAIR KIT

OEM #
88936044
APPLICATION
GENERAL MOTORS
AXLES

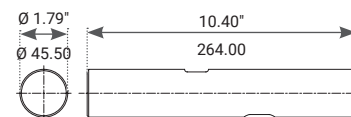

780.578

KING PIN REPAIR KIT

OEM #
15619561
APPLICATION
GENERAL MOTORS
AXLES

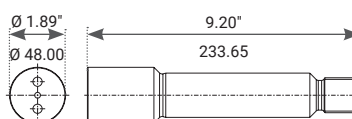

Technical drawing of a cylindrical component. The drawing shows a side view of the cylinder with a diameter of $\varnothing 1.36''$ and a length of $8.07''$. A cross-sectional view on the left shows the internal structure with a diameter of $\varnothing 34.50$. The overall length is also indicated as 205.00 .

360.010

KING PIN REPAIR KIT

OEM #
474520C91

APPLICATION

INTERNATIONAL
NAVISTAR 3700, 3800,
3900, 4600, 4700,
4800, 4900, 7100,
8100, 8200, 8300,
9300, 9400, 9600,
9700, CARGOSTAR,
FLEETSTAR, PAYSTAR,
S SERIES TRUCKS

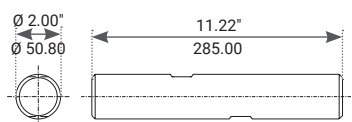

360.010PR

KING PIN REPAIR KIT

OEM #
597258C91

APPLICATION

INTERNATIONAL
NAVISTAR 3700, 3800,
3900, 4600, 4700,
4800, 4900, 7100,
8100, 8200, 8300,
9300, 9400, 9600,
9700, CARGOSTAR,
FLEETSTAR, PAYSTAR,
S SERIES TRUCKS

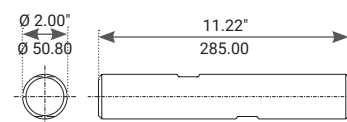

780.398

KING PIN REPAIR KIT

OEM #

APPLICATION
INTERNATIONAL
NAVISTAR AXLES

**NO
REAM**

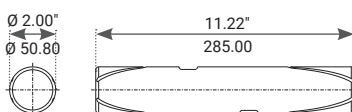

360.011

KING PIN REPAIR KIT

OEM #
1651921C91

APPLICATION
INTERNATIONAL
NAVISTAR 8100,
8200, 8300, 9300,
9400, 9600, 9700, S
SERIES EFA12 MODEL
TRUCKS

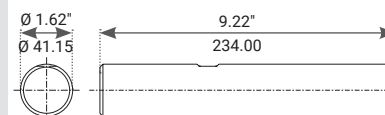

KING PIN REPAIR KIT

OEM #
1651921C91S

APPLICATION
INTERNATIONAL
NAVISTAR TRUCKS

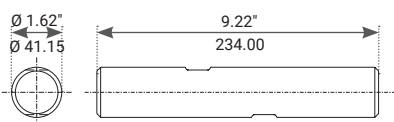

KING PIN REPAIR KIT

OEM #
2500542C91

APPLICATION
INTERNATIONAL
NAVISTAR FF981 ,
ARK, ARL, ASB, ASD
SERIES TRUCKS

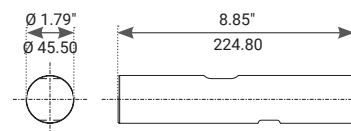

KING PIN REPAIR KIT

OEM #
2500542C91

APPLICATION
INTERNATIONAL
NAVISTAR FF981 ,
ARK, ARL, ASB, ASD
SERIES TRUCKS

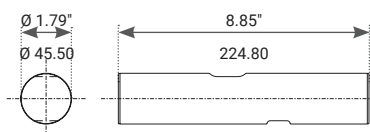

KING PIN REPAIR KIT

OEM #
2500542C91

APPLICATION
INTERNATIONAL
NAVISTAR FF981,
ARK, ARL, ASB, ASD
SERIES MODEL
AXLES

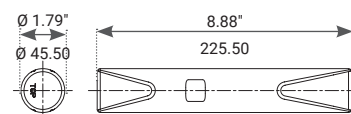

540.028

KING PIN REPAIR KIT

OEM #
1665531C91
APPLICATION
INTERNATIONAL
NAVISTAR 2000,
8000, 9000, S SERIES
TRUCKS

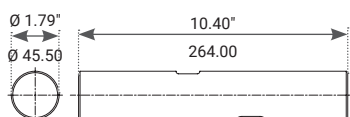

540.028PR

KING PIN REPAIR KIT

OEM #
1665531C91
APPLICATION
INTERNATIONAL
NAVISTAR 2000,
8000, 9000, S SERIES
TRUCKS

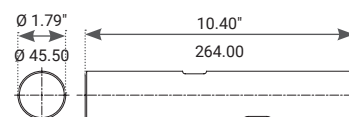

780.397

KING PIN REPAIR KIT

OEM #
1665531C91
2505492C91
APPLICATION
INTERNATIONAL
NAVISTAR TRUCKS

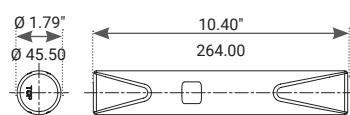

580.012

KING PIN REPAIR KIT

OEM #
399942C93
APPLICATION
INTERNATIONAL
NAVISTAR 5000/
5370, PAYSTAR,
CARGOSTAR,
FLEETSTAR, 1400-
2100/ 2200-2600
SERIES TRUCKS

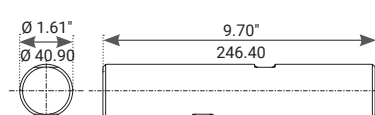

KING PIN REPAIR KIT

OEM #

1658934C93

APPLICATION

INTERNATIONAL
NAVISTAR 5000/
5370, PAYSTAR,
CARGOSTAR,
FLEETSTAR, 1400-
2100/ 2200-2600
SERIES TRUCKS

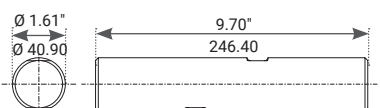

580.013

KING PIN REPAIR KIT

OEM #

1660271C91

1660271C92

APPLICATION

INTERNATIONAL
NAVISTAR 3700,
3800, 3900, 4600,
4700, 4800, 4900,
7100, S SERIES
TRUCKS

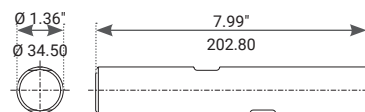

580.013PR

KING PIN REPAIR KIT

OEM #

1660271C91

1660271C92

APPLICATION

INTERNATIONAL
NAVISTAR 3700,
3800, 3900, 4600,
4700, 4800, 4900,
7100, S SERIES
TRUCKS

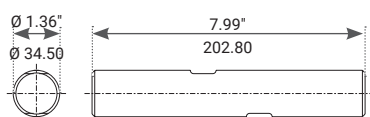

270.032

KING PIN REPAIR KIT

OEM #

1660271C92

APPLICATION

APPLICATION
INTERNATIONAL
NAVISTAR 3700,
3800, 3900, 4600,
4700, 4800, 4900,
7100, S SERIES
TRUCKS FA71, FA73
MODEL TRUCKS

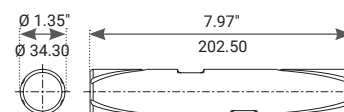

580.014

KING PIN REPAIR KIT

OEM #
S-D562

APPLICATION
INTERNATIONAL
NAVISTAR 12000
SERIES AED, AEG
MODEL TRUCKS

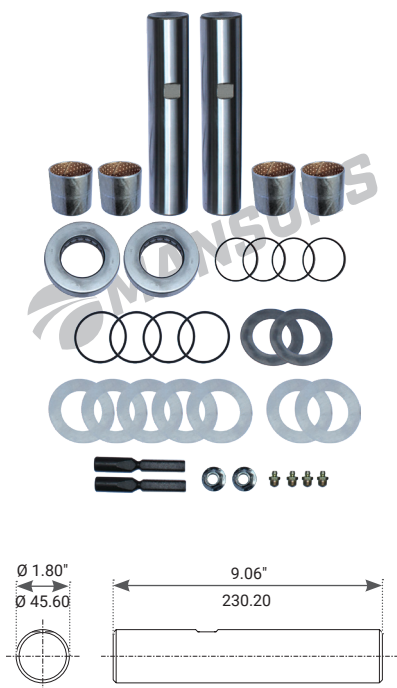

580.024

KING PIN REPAIR KIT

OEM #
1668411C92

APPLICATION
INTERNATIONAL
NAVISTAR 9200,
9300, 9400, 3700,
3800, 3900, 4600,
4700, 4800, 4900
SERIES TRUCKS



580.025

KING PIN REPAIR KIT

OEM #
1668411C91
1668411C92

APPLICATION
INTERNATIONAL
NAVISTAR 3700,
3800, 3900, 4600,
4700, 4800, 4900,
7100, 8100, 8200,
8300, 9200, 9300,
9400 SERIES TRUCKS

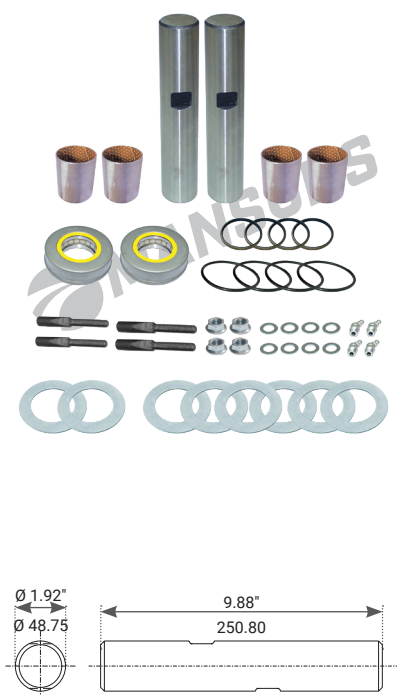

580.025PR

KING PIN REPAIR KIT

OEM #
1668411C91
1668411C92

APPLICATION
INTERNATIONAL
NAVISTAR 3700,
3800, 3900, 4600,
4700, 4800, 4900,
7100, 8100, 8200,
8300, 9200, 9300,
9400 SERIES TRUCKS

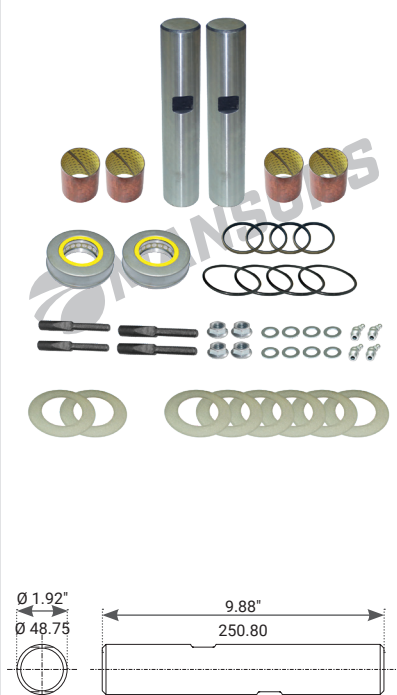

KING PIN REPAIR KIT

OEM #
2505492C91

APPLICATION

**INTERNATIONAL
NAVISTAR 8100,
8200, 8300, 9200,
9300, 9400, S SERIES
TRUCKS**

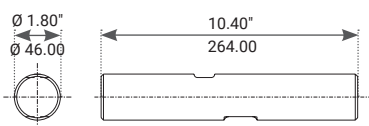

KING PIN REPAIR KIT

OEM #
1668412C91
1668412C92

APPLICATION

INTERNATIONAL
NAVISTAR 9200,
9300, 9400, 3700,
3800, 3900, 4600,
4700, 4800, 4900
SERIES TRUCKS

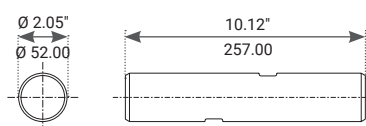

KING PIN REPAIR KIT

OEM #
549800C91

APPLICATION

INTERNATIONAL
NAVISTAR 8100,
8200, 8300, 9600,
9700, S, TRANSTAR
SERIES FA226,
FF941, FF942, 02226,
02227, FA227, FA223,
FF931, FA226 MODEL
TRUCKS

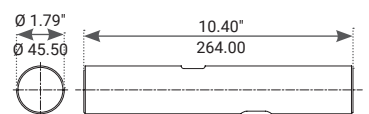

KING PIN REPAIR KIT

OEM #
2603340C91

APPLICATION

INTERNATIONAL
NAVISTAR AXLES

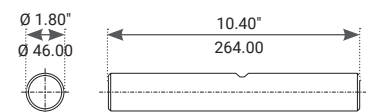



780.165

KING PIN REPAIR KIT

OEM #
1662306C91
APPLICATION
INTERNATIONAL
NAVISTAR FLEETSTAR,
LOADSTAR, TRANSTAR
SERIES FA225, FA228
MODEL AXLES

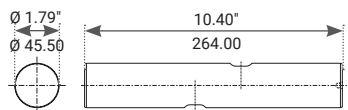

780.238

KING PIN REPAIR KIT

OEM #
2505495C91
APPLICATION
INTERNATIONAL
NAVISTAR 18000
SERIES ARU MODEL
TRUCKS

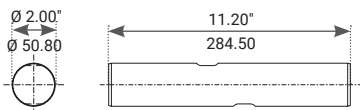

Technical drawing of a rectangular plate. The drawing shows a top view and a side view. The top view is a rectangle with a width of 10.40 inches and a length of 264.00 inches. A circular hole with a diameter of 1.79 inches is located on the left side. The side view shows the thickness of the plate, which is 0.4550 inches.

Technical drawing of a cylindrical component. The front view shows a cylinder with a diameter of 1.89 inches and a length of 9.20 inches. The side view shows a cylinder with a diameter of 233.65 inches. The drawing includes dimension lines and labels for the diameter and length.

560.007

KING PIN REPAIR KIT

OEM #
301SQ47CP1
301SQ47D
301SQ47E
APPLICATION
MACK DM, RM,
DUMP, MIXER, FA523,
FA532, FA538, CH600,
MB400-600 CONICAL
SERIES TRUCKS

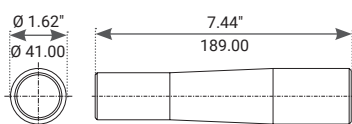

560.188

KING PIN REPAIR KIT

OEM #
301SQ47E
APPLICATION
MACK DM, RM, DUMP,
MIXER, REFUSE
SERIES MODEL
FA522, FA523, FA532,
FA538 SERIES MODEL
AXLES, CH600,
MB400-600 CONICAL
SERIES TRUCKS

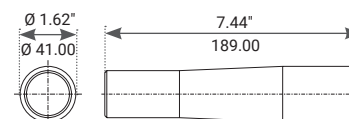

560.008

KING PIN REPAIR KIT

OEM #
301SQ52
301SQ52A
APPLICATION
MACK DM, RM, DUMP,
MIXER, REFUSE
SERIES FA 616, FA
617 MODEL AXLES

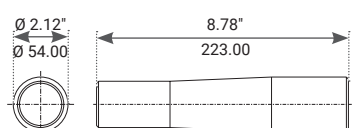

560.244

KING PIN REPAIR KIT

OEM #
301SQ52
301SQ52A
APPLICATION
MACK DM, RM, DUMP,
MIXER, REFUSE
SERIES FA 616, FA
617 MODEL AXLES

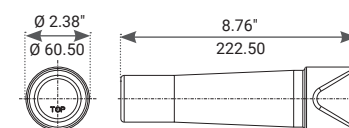

800.104

KING PIN REPAIR KIT

OEM #
301SQ53

APPLICATION
MACK DM, RM,
DUMP, MIXER,
REFUSE SERIES
FXL12 /14.6/18 &
VF12, FXL20/23 &
VF23 SERIES MODEL
AXLES

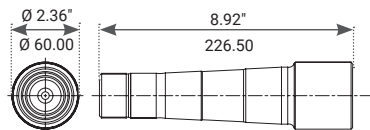

560.245

KING PIN REPAIR KIT

OEM #
301SQ52A

APPLICATION
MACK 12000# FXL12,
14600# FXL14.6
SERIES MODEL
AXLES

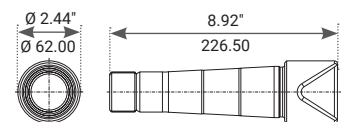

800.121

KING PIN REPAIR KIT

OEM #
41035000793358S1

APPLICATION
MACK / RENAULT ME,
SE, CE 160/180/210,
JE 13/15, S170
SERIES TRUCKS

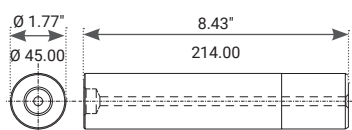

800.121S

KING PIN REPAIR KIT

OEM #
5000793358KPB

APPLICATION
MACK / RENAULT ME,
SE, CE 160/180/210,
JE 13/15, S170
SERIES TRUCKS



WITH BEARING

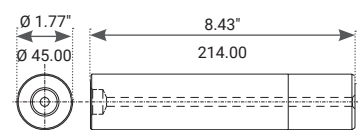

130.001

KING PIN REPAIR KIT

OEM #
R200304
APPLICATION
MERITOR 02AEM
AFTER 10/2002
SERIES AXLES

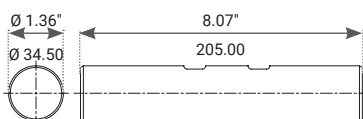

270.034

KING PIN REPAIR KIT

OEM #
R202009
APPLICATION
MERITOR AXLES

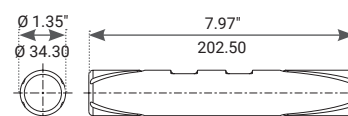

130.023

KING PIN REPAIR KIT

OEM #
R201336
APPLICATION
MERITOR MFS
SERIES AXLES

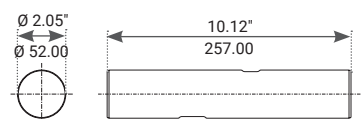

130.023PR

KING PIN REPAIR KIT

OEM #
R201336
APPLICATION
MERITOR MFS
SERIES AXLES

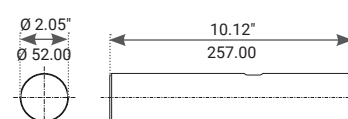

270.001

KING PIN REPAIR KIT

OEM #
R200301
APPLICATION
MERITOR AXLES

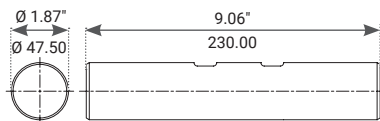

270.001PR

KING PIN REPAIR KIT

OEM #
R201327
APPLICATION
MERITOR AXLES

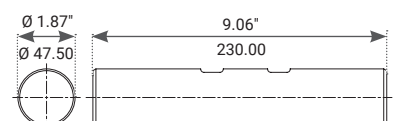

270.033

KING PIN REPAIR KIT

OEM #
R202006
APPLICATION
MERITOR AXLES

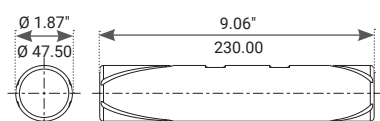

340.002

KING PIN REPAIR KIT

OEM #
R200051
APPLICATION
MERITOR FF931
SERIES AXLES

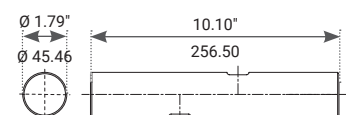

Technical drawing of a cylindrical part. The drawing includes two views: a front view (top) and a side view (bottom). The front view shows a cylinder with a diameter of 1.05 inches and a length of 6.70 inches. The side view shows the cylinder with a diameter of 26.70 inches and a length of 170.00 inches.

Technical drawing of a cylindrical part. The left view is a cross-section showing an outer diameter of $\varnothing 2.00''$ and an inner diameter of $\varnothing 50.80$. The right view is a side elevation showing a length of $11.22''$ and 285.00 .

780.398

KING PIN REPAIR KIT

OEM #
R202014

APPLICATION
MERITOR FL931,
FL933, FL941, FL943
SERIES AXLES

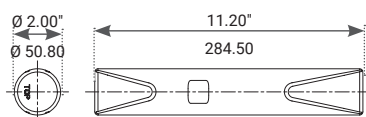

360.011

KING PIN REPAIR KIT

OEM #
R200267

APPLICATION
MERITOR AXLE

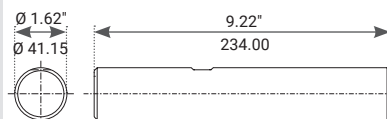

360.012

KING PIN REPAIR KIT

OEM #
R200269

APPLICATION
MERITOR AXLES

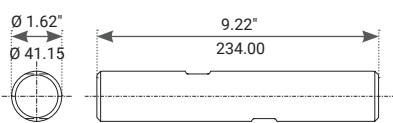

270.031

KING PIN REPAIR KIT

OEM #
R202007

APPLICATION
MERITOR EFA12F4
SERIES AXLES

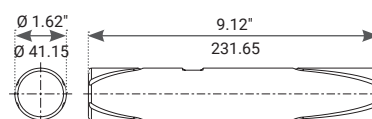

360.204

KING PIN REPAIR KIT

OEM #
R200305
APPLICATION
MERITOR FF981,
MFS10, MFS12,
MFS13 SERIES AXLES



360.204PR

KING PIN REPAIR KIT

OEM #
R201419
APPLICATION
MERITOR FF981,
MFS10, MFS12,
MFS13 SERIES AXLES



780.399

KING PIN REPAIR KIT

OEM #
R202003
APPLICATION
MERITOR FF981,
MFS10, MFS12,
MFS13 SERIES AXLES



540.028

KING PIN REPAIR KIT

OEM #
R201315
APPLICATION
MERITOR FD961,
FF931, FF932, FF933,
FF934, FF941, FF942,
FF943, FF944, FF961,
FF962, MFS10, MFS12
SERIES MODEL AXLES



540.028PR

KING PIN REPAIR KIT

OEM #
R201315

APPLICATION
MERITOR FD961,
FF931, FF932, FF933,
FF934, FF941, FF942,
FF943, FF944, FF961,
FF962, MFS10, MFS12
SERIES MODEL AXLES

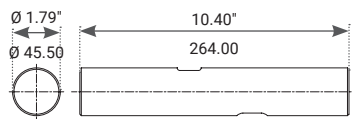

780.397

KING PIN REPAIR KIT

OEM #
R202002

APPLICATION
MERITOR FF961,
FF941 SERIES AXLES

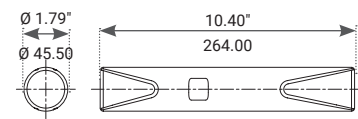

560.007

KING PIN REPAIR KIT

OEM #
R200065

APPLICATION
MERITOR AXLES

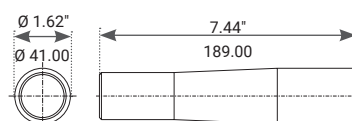

560.008

KING PIN REPAIR KIT

OEM #
R200071

APPLICATION
MERITOR AXLES

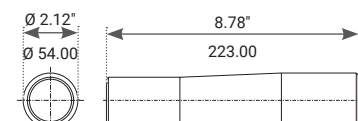

560.244

KING PIN REPAIR KIT

OEM #
R202026

APPLICATION
MERITOR FA 616, FA
617 SERIES AXLES

**NO
REAM**

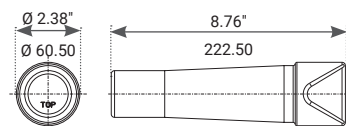

560.245

KING PIN REPAIR KIT

OEM #
R202035

APPLICATION
MERITOR AXLES

**NO
REAM**

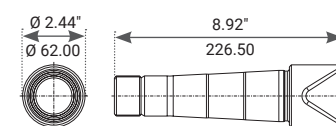

580.012

KING PIN REPAIR KIT

OEM #
R200042

APPLICATION
MERITOR AXLES

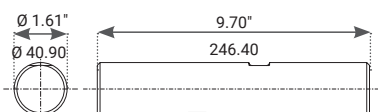

580.012PR

KING PIN REPAIR KIT

OEM #
R200278

APPLICATION
MERITOR AXLES

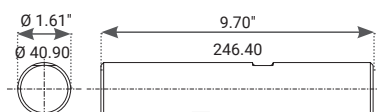

580.013

KING PIN REPAIR KIT

OEM #
R200268

APPLICATION
MERITOR FA71, FA73
MODEL AXLES

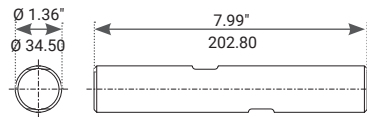

580.013PR

KING PIN REPAIR KIT

OEM #
R201331

APPLICATION
MERITOR FA71, FA73
SERIES AXLES

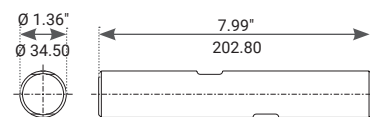

270.032

KING PIN REPAIR KIT

OEM #
R202005

APPLICATION
MERITOR AXLES

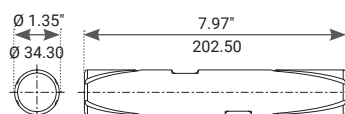

580.014

KING PIN REPAIR KIT

OEM #
R200281

APPLICATION
MERITOR AXLES

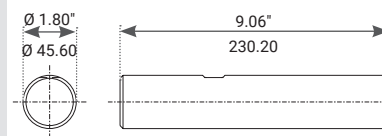

270.035

KING PIN REPAIR KIT

OEM #
R202001
APPLICATION
MERITOR AXLES



580.025

KING PIN REPAIR KIT

OEM #
R201426
APPLICATION
MERITOR AXLES

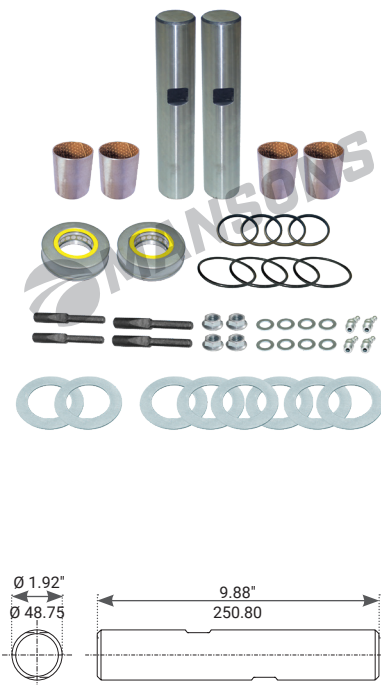

580.025PR

KING PIN REPAIR KIT

OEM #
R201486
APPLICATION
MERITOR AXLES

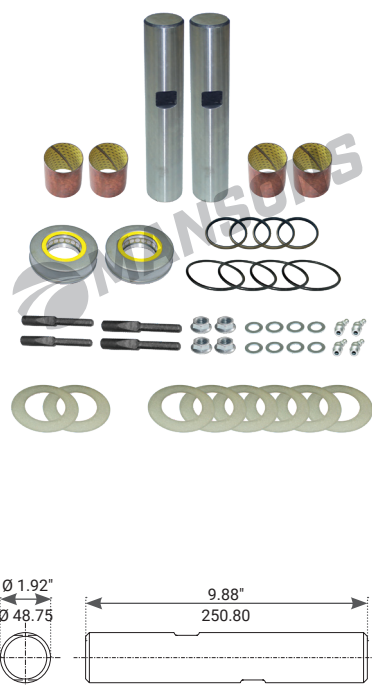

580.026

KING PIN REPAIR KIT

OEM #
KIT1315
R201315
APPLICATION
MERITOR 600 SERIES
FF941/ 942/ 943/
944/ 945, FF961/
962/ 966/ 967, FC965,
MFS12 SERIES
MODEL AXLES



740.001

KING PIN REPAIR KIT

OEM #
KIT195
R200195

APPLICATION
MERITOR FF931,
FF932, FF933, FF934,
FF941, FF942, FF943,
FF944, FF961, FF962
SERIES MODEL
AXLES

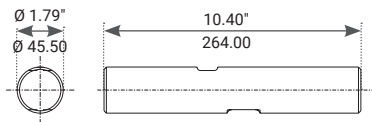

780.163

KING PIN REPAIR KIT

OEM #
R201310

APPLICATION
MERITOR FG931,
FG933, FG940 (02ARG),
FG941, FG943, FG941
SERIES AXLES

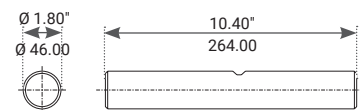

780.165

KING PIN REPAIR KIT

OEM #
KIT199
R200193

APPLICATION
MERITOR FF921,
FF923, FF931, FG931
SERIES MODEL
AXLES

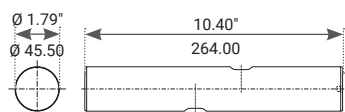

780.238

KING PIN REPAIR KIT

OEM #
R201475

APPLICATION
MERITOR MFS16,
MFS18, MFS73
SERIES AXLES

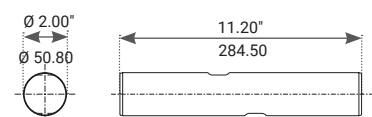

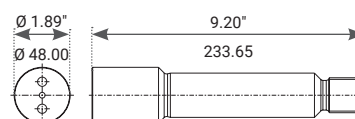
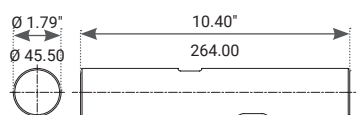
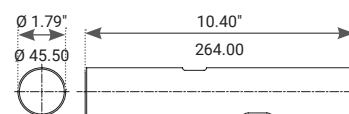
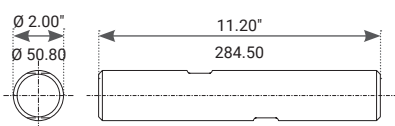

780.579

KING PIN REPAIR KIT

OEM #
R003200

APPLICATION
MERITOR AXLES

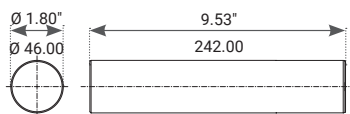

780.580

KING PIN REPAIR KIT

OEM #
R200280

APPLICATION
MERITOR 7000-9000
SERIES MODEL
AXLES

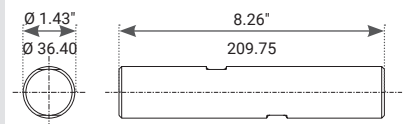

780.581

KING PIN REPAIR KIT

OEM #
R201479

APPLICATION
MERITOR NON-
DRIVING FRONT
STEERING MFS-07
SERIES AXLES

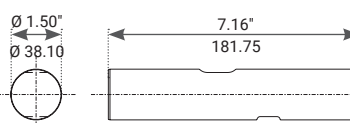

710.013

KING PIN REPAIR KIT

OEM #
KP706BS

APPLICATION
MITSUBISHI FUSO
CANTER TRUCKS

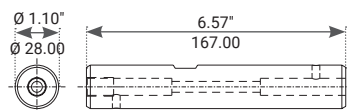

600.099

KING PIN REPAIR KIT

OEM #
3434365700S1

APPLICATION
SAF HOLLAND SL9
4218, SL11 4220,
SZL11 4218/ 4220,
ZL8 3718, ZL9 3020/
3720, ZL11 3720/
4220 SERIES STEER
AXLES

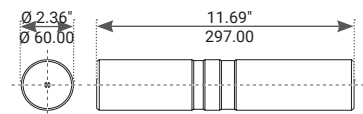

KING PIN REPAIR KIT

APPLICATION

VOLVO WHITE TRUCKS

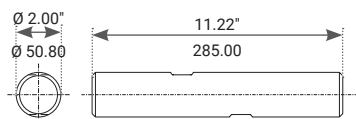

KING PIN REPAIR KIT

APPLICATION
VOLVO WHITE
TRUCKS

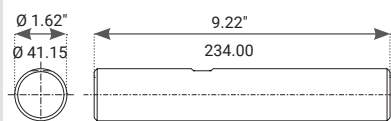

KING PIN REPAIR KIT

OEM #
V1112810S

APPLICATION
VOLVO WHITE
TRUCKS

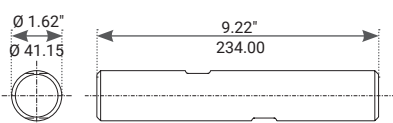

KING PIN REPAIR KIT

OEM #
3093704

APPLICATION
VOLVO VF14, VF16,
VF18 SERIES AXLES

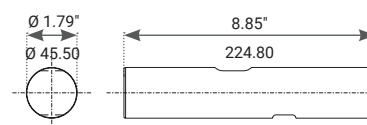

360.204PR

KING PIN REPAIR KIT

OEM #
3093704
APPLICATION
VOLVO WHITE
TRUCKS

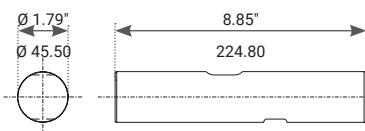

740.001

KING PIN REPAIR KIT

OEM #
370905000
APPLICATION
VOLVO WHITE
TRUCKS

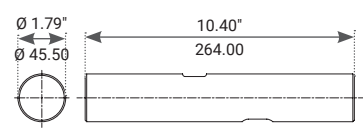

780.165

KING PIN REPAIR KIT

OEM #
027091941
APPLICATION
VOLVO WHITE
TRUCKS

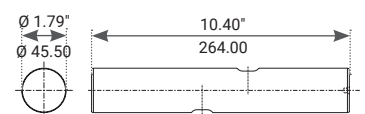

800.104

KING PIN REPAIR KIT

OEM #
85108338
APPLICATION
VOLVO FM9, FM12
SERIES AXLES

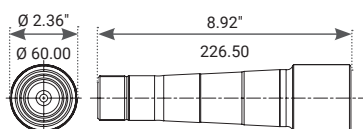

560.245

KING PIN REPAIR KIT

OEM #
85108338

APPLICATION
VOLVO FM9, FM12
SERIES AXLES



10.560

KING PIN REPAIR KIT

OEM #
85104370
85104371

APPLICATION
VOLVO WHITE
TRUCKS



780.397

KING PIN REPAIR KIT

OEM #
SRK102

APPLICATION
WATSON & CHALIN
11 SERIES WITH
MERITOR AXLES

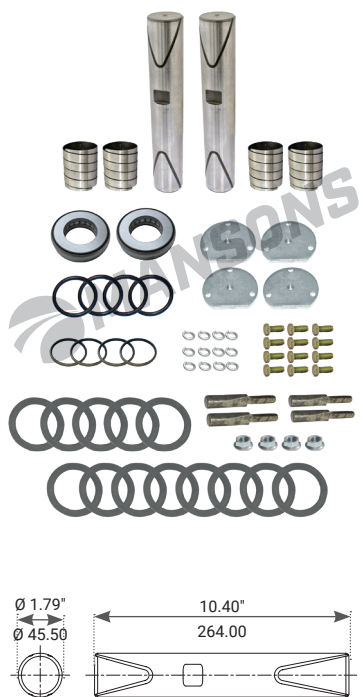

FOR TERMS & CONDITIONS PLEASE VISIT OUR WEBSITE

Reference in this catalogue to OEM / third party names, part numbers / OEM numbers is only for information on OEM / third party parts corresponding to Mansons components & does not imply any connection / affiliations between Mansons & the OEM.

NOTES





NPA 959

NORTH AMERICAN TRUCK & TRAILER KING PIN KITS
